



BLEU PROVENCE

Bath & Taps





-  **Bleu Provence** vi offre solo prodotti di alta qualità, fabbricati con materiali e componenti di prima scelta, finiti con cura e precisione. Le ns. creazioni sono destinate a restare intatte nel tempo, a non passare di moda, e a rendere la vostra casa più calorosa ed accogliente.
-  **Bleu Provence** vous offre uniquement des produits de grande qualité, fabriqués avec des matériaux et composants de premier choix, finis avec soin et précision. Nos créations sont destinées à durer dans le temps, à rester indémodables et à rendre votre maison plus chaleureuse et accueillante.
-  **Bleu Provence** offers only high quality products, made with first choice materials and components, finished with care and precision. Our creations are designed to last over time, to remain fashion and make your home warm and cozy.



Cast iron bathtubs with feet pag.03

Cast iron bathtubs with base pag.11

Recessed cast iron bathtubs pag.32

Taps pag.36

Heated towel rails pag.64

Metal finishes pag.82

La ghisa una scelta sicura ed ecologica. Un investimento di qualità per il vostro bagno!
Le vasche in ghisa ritornano prepotentemente nei ns. bagni e non è soltanto per la loro bellezza ma perchè in realtà offrono parecchi vantaggi e qualità che non hanno le vasche in acrilico, acciaio o altre materie, che richiedono un investimento un po' piu' importante ma che poi si dimostra intelligente nel tempo :

- **Una scelta ecologica:** la ghisa smaltata è riciclabile contrariamente all'acrilico
- **Una scelta di igiene:** lo smalto delle vasche offre una resistenza senza paragoni alla proliferazione batterica. Questa è la ragione per cui hotels e ospedali da sempre privilegiano la ghisa nella loro scelta.
- **Una scelta di sicurezza:** la ghisa è un materiale non infiammabile che non emette alcun gas o fumo tossico in caso d'incendio
- **Una scelta contro l'inquinamento sonoro:** la ghisa assorbe al massimo i rumori dell'acqua e del bagno rispetto all'acrilico e ferro.
- **Una scelta che dura nel tempo:** contrariamente all'acrilico, le vache in ghisa sono indeformabili. Una solidità a prova di tutto e che offre caratteristiche inalterabili nel tempo, una durata e resistenza eccezionale al fuoco, agli urti, e ai prodotti chimici.
- **Una scelta di confort:** le caratteristiche naturali della ghisa offrono una capacità termica massima che vi garantisce la temperatura dell'acqua a lunga durata senza aggiungere acqua calda facendo delle economie.
- **Una manutenzione facile:** materiale denso e non poroso per eccellenza, lo smalto non trattiene ne calcaire ne altri depositi, facilitando la pulizia. Tutte queste qualità valgono ampiamente il piccolo sovraccosto della ghisa rispetto altri materiali. E poi riportato alla durata di vita del prodotto stesso che puo' durare fino a 100 anni, il calcolo di convenienza per questo investimento è presto fatto.

La Fonte : un matériau sécuritaire et écologique. Un investissement de choix pour votre salle de bain !
Les baignoires en fonte émaillée reviennent en force dans nos salles de bain...et ce n'est pas uniquement parce qu'elles sont belles et racées. En effet, elles offrent de nombreuses qualités et avantages que n'ont pas les baignoires en acrylique ou en acier et qui, en dépit d'un investissement un peu plus important, en font un choix malin pour ne pas dire indispensable :

- **Un choix écologique :** la fonte émaillée est recyclable contrairement à l'acrylique
- **Un choix sanitaire :** l'émail des baignoires en fonte offre une résistance sans égal à la prolifération bactérienne. C'est pour cette raison qu'hôtels et hôpitaux doivent privilégier la fonte dans leurs choix d'installations sanitaires.
- **Un choix sécuritaire :** la fonte est un matériau ininflammable n'offrant aucun dégagement de gaz ou de fumées toxiques en cas d'incendie
- **Un choix contre la pollution sonore :** la fonte émaillée absorbe un maximum des bruits d'eau et du bain contrairement aux baignoires acryliques ou en acier.
- **Un choix ancré dans le temps :** contrairement à celles en acrylique, les baignoires en fonte sont parfaitement indéformables. D'une solidité à toute épreuve, elles offrent des caractéristiques d'inaltérabilité, de durabilité et une résistance exceptionnelle au feu, aux chocs et aux produits chimiques.
- **Un choix de confort :** les caractéristiques naturelles de la fonte offrent une capacité thermique maximale vous garantissant un bain à bonne température longtemps sans rajout d'eau chaude et aussi par là même de substantielles économies.
- **Un choix d'entretien facile:** matériau dense et non poreux par excellence, l'émail n'accroche ni le calcaire ni d'autres dépôts ce qui facilite grandement son entretien. Toutes ces qualités valent largement le petit surcoût supplémentaire lors de l'acquisition d'une baignoire en fonte comparé à une baignoire en acrylique. Et puis, ramené à la durée de vie d'un tel produit qui peut aller jusqu'à plus de 100 ans, le calcul de rentabilité de son investissement est vite fait.

Enameled cast iron : a safe and ecological material . A smart choice for your bathroom!
Enameled cast iron bathtubs are back for good in our bathrooms ... and this is not only because they are beautiful. Indeed, they offer many features and benefits that do not have the acrylic or steel bathtubs. And despite a slightly larger investment , they do represent a smart if not essential choice for many reasons:

- **An ecological choice:** cast iron is recyclable unlike acrylic. Therefore it does protect our planet!
- **A health choice :** enamel cast iron bathtubs offer unmatched resistance to bacterial proliferation. . It is this essential characteristic that leads hospitals and Palace hotels to favor cast iron bath tubs in their Bathrooms.
- **A safe choice :** the cast is a non flammable material. It does not release gas or toxic fumes in case of fire unlike acrylic
- **An anti noise pollution choice :** Cast iron ideally absorbs all noise of water and bath unlike steel or acrylic. It offers you a quiet bath everyday
- **A long term investment choice :** A rock solid, enameled cast iron offers exceptional features of inalterability, durability and exceptional resistance to fire, impacts and chemicals. They are also perfectly non-deformable unlike those in acrylic
- **A comfort choice:** The natural characteristics of the cast offer maximum thermal capacity.

You keep the assurance of a good bath temperature without addition of hot water or losing the heat too fast like with acrylic tubs.

- **A maintenance easy choice :** The enamel is a dense, non-porous material which does get limestone or other potential deposits. Maintenance and cleaning is therefore very easy. All these qualities are well worth the extra cost when buying a cast iron bathtub compared to acrylic or steel bathtub . And your return on investment is even more obvious when you consider that such product has a life cycle of more than 100 years!



Tecnico

Valvola di scarico disponibile da 63 mm. Overflow hole available with 63mm Misure approssimative - Approximate measurements

INFORMAZIONI TECNICHE - TECHNICAL INFORMATION

Opzione - Option

DIMENSIONI - DIMENSIONS (mm)

1370	1370	765	445	1226	600	582	-	353	779	290	-	740	580	-	-	-	-
1540	1540	765	445	1380	600	582	-	353	779	290	-	740	580	-	-	-	-
1700	1700	760	450	1548	608	580	-	370	795	300	-	730	578	-	-	-	-
	A	B	C	D	E	F	G	H	I	J	L	M	N	O	P	Q	R

1370

KG

102

LT

VOL.

165

1540

KG

120

LT

VOL.

180

1700

KG

129

LT

VOL.

205



Piede Lavande

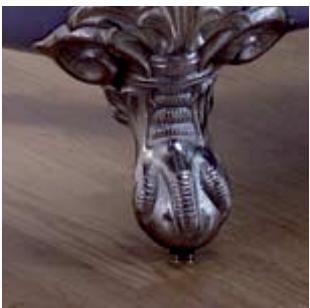

Piede Vintage



Piede Fleur



Old Lavande



Old Lavande con anelli



Vintage

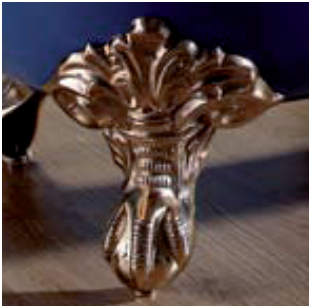

Piede Vintage



Piede Fleur

Tecnico

Valvola di scarico disponibile da 63 mm.

Overflow hole available with 63mm

Misure approssimative - Approximate measurements

INFORMAZIONI TECNICHE - TECHNICAL INFORMATION

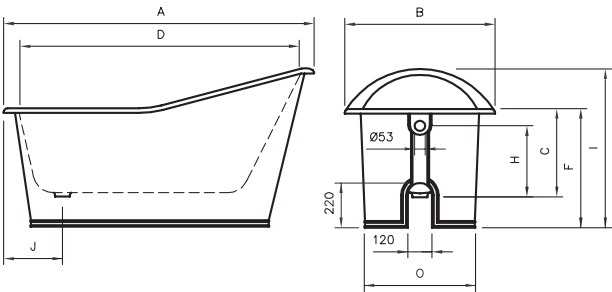

DIMENSIONI - DIMENSIONS (mm)

	1370	1540	1700
A	1370	1540	1700
B	765	765	765
C	445	445	445
D	1226	1380	1548
E	600	600	608
F	585	585	585
G	-	353	370
H	755	755	755
I	290	290	300
J	-	740	730
K	580	580	578
L	550	550	550
M	-	-	-
N	-	-	-
O	-	-	-
P	-	-	-
Q	-	-	-
R	-	-	-

1370	1540	1700
KG	KG	KG
LT	LT	LT
155	163	170
165	180	205

Tecnico

Valvola di scarico disponibile da 63 mm.

Overflow hole available with 63mm

Misure approssimative - Approximate measurements

INFORMAZIONI TECNICHE - TECHNICAL INFORMATION

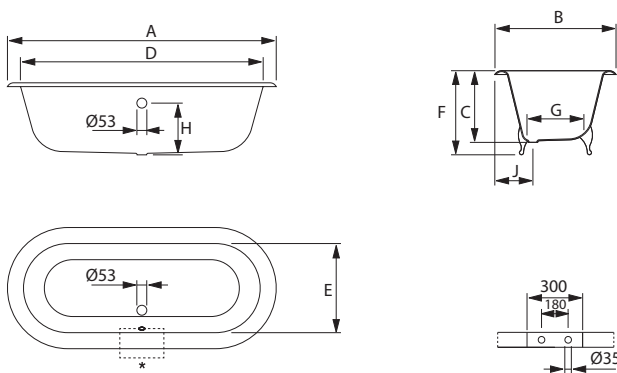

DIMENSIONI - DIMENSIONS (mm)

	1540	1700
A	1540	1700
B	780	780
C	473	475
D	1410	1560
E	620	620
F	585	585
G	450	450
H	370	372
I	-	-
J	285	275
L	-	-
M	-	-
N	-	-
O	-	-
P	-	-
Q	-	-
R	-	-

1540	1700
KG	KG
LT	LT
113	129
170	190

Anis



Piede Anis



Piede Vintage



Piede Lavande



Piede Fleur

Thym



Piede Lion

Tecnico

Valvola di scarico disponibile da 63 mm.

Overflow hole available with 63mm

Misure approssimative - Approximate measurements

INFORMAZIONI TECNICHE - TECHNICAL INFORMATION

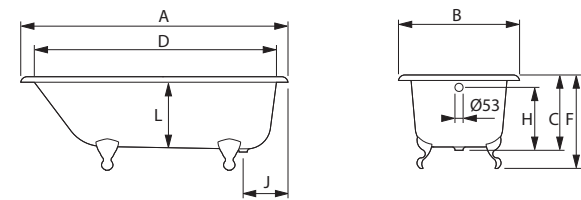

Opzione - Option

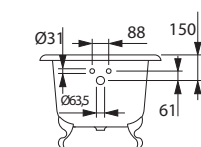

DIMENSIONI - DIMENSIONS (mm)

	A	B	C	D	E	F	G	H	I	J	L	M	N	O	P	Q	R
1370	1370	765	455	1240	615	590	-	363	-	290	430	-	-	-	-	-	-
1540	1540	770	470	1400	615	610	-	383	-	290	440	-	-	-	-	-	-
1700	1700	775	473	1580	615	610	-	390	-	290	440	-	-	-	-	-	-

1370		1540		1700	
KG	LT	KG	LT	KG	LT
99	175	117	200	131	225

Tecnico

Valvola di scarico disponibile da 63 mm.

Overflow hole available with 63mm

Misure approssimative - Approximate measurements

INFORMAZIONI TECNICHE - TECHNICAL INFORMATION

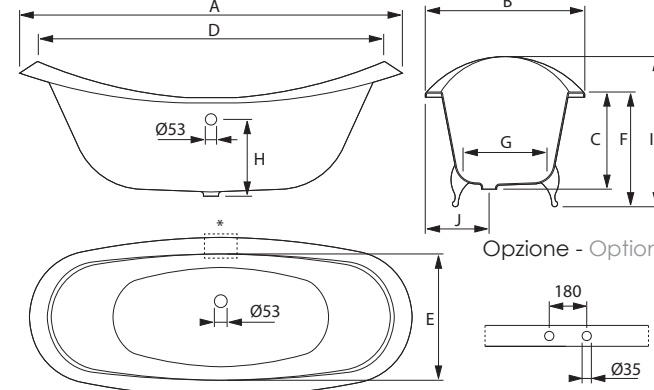

Opzione - Option

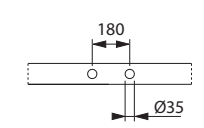

DIMENSIONI - DIMENSIONS (mm)

	A	B	C	D	E	F	G	H	I	J	L	M	N	O	P	Q	R
1540	1540	750	402	1400	610	535	420	308	730	300	-	-	-	-	-	-	-
1700	1700	760	460	1550	600	595	420	360	770	300	-	-	-	-	-	-	-
1800	1800	770	462	1660	610	595	420	368	790	300	-	-	-	-	-	-	-

1540		1700		1800	
KG	LT	KG	LT	KG	LT
110	175	127	185	139	195

Jasmine



Piede Jasmine

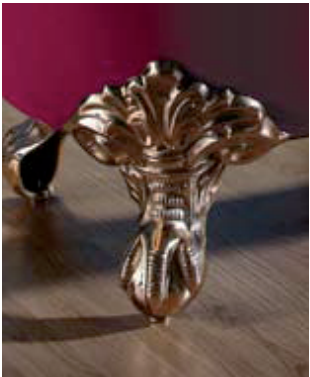

Piede Vintage



Piede Fleur

Romarin



Piede Romarin

Tecnico

Valvola di scarico disponibile da 63 mm.

Overflow hole available with 63mm

Misure approssimative - Approximate measurements

INFORMAZIONI TECNICHE - TECHNICAL INFORMATION

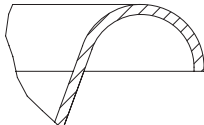
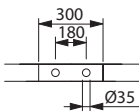
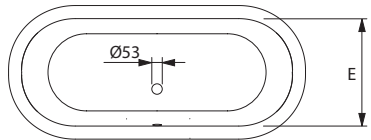
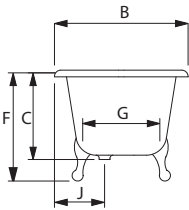
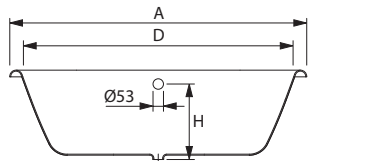

DIMENSIONI - DIMENSIONS (mm)

1780	1780	800	543	1640	660	675	450	465	-	290	-	-	-	-	-	-	-
A	B	C	D	E	F	G	H	I	J	L	M	N	O	P	Q	R	

1700	
KG	LT
PESO/WEIGHT	VOL.
154	240

Tecnico

Valvola di scarico disponibile da 63 mm.

Overflow hole available with 63mm

Misure approssimative - Approximate measurements

INFORMAZIONI TECNICHE - TECHNICAL INFORMATION

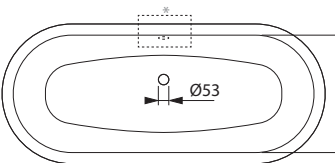
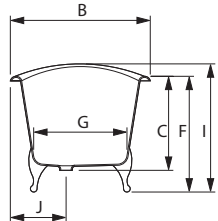
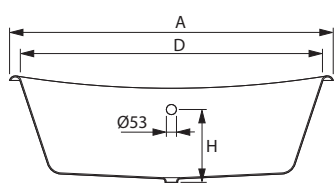

Opzione - Option

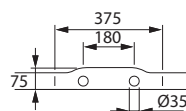

DIMENSIONI - DIMENSIONS (mm)

1700	1700	680	492	1620	585	620	465	390	675	250	-	-	-	-	-	-	-
A	B	C	D	E	F	G	H	I	J	L	M	N	O	P	Q	R	

1700	
KG	LT
PESO/WEIGHT	VOL.
133	215

Quadro

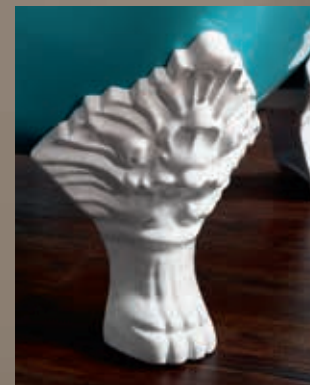

Piede Jasmine



Tecnico

Valvola di scarico disponibile da 63 mm.

Overflow hole available with 63mm

Misure approssimative - Approximate measurements

INFORMAZIONI TECNICHE - TECHNICAL INFORMATION

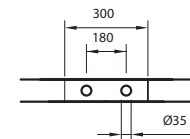
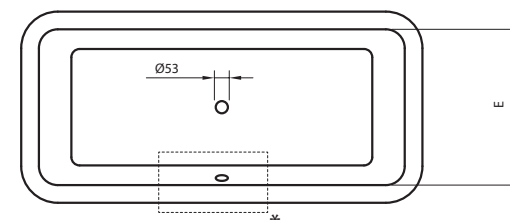
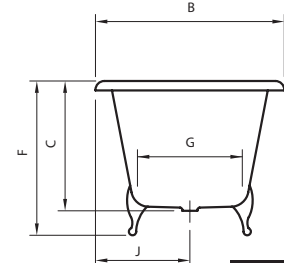
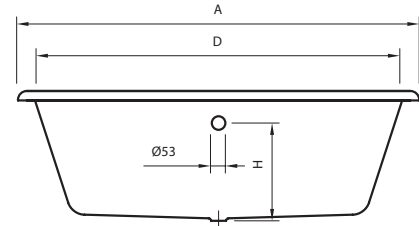

KG	LT
PESO/WEIGHT	VOL.
124	220

🇮🇹 Vasca in ghisa rettangolare molto profonda.

🇫🇷 Baignoire en fonte rectangulaire de grande profondeur.

🇬🇧 Rectangular & deep cast iron bathtub.

1700	1700	810	562	1550	660	685	480	460	-	405	-	-	-	-	-	-
A	B	C	D	E	F	G	H	I	J	L	M	N	O	P	Q	R

Baignoires avec base 🇫🇷
Vasche con base 🇮🇹

Bathtubs with base



Vintage
su base
sur base
on base



Anis
su base
sur base
on base



Thym
su base
sur base
on base

Luxury

Luxury rame
cuivre
copper



Tecnico

Valvola di scarico disponibile da 63 mm.

Overflow hole available with 63mm

Misure approssimative - Approximate measurements

INFORMAZIONI TECNICHE - TECHNICAL INFORMATION

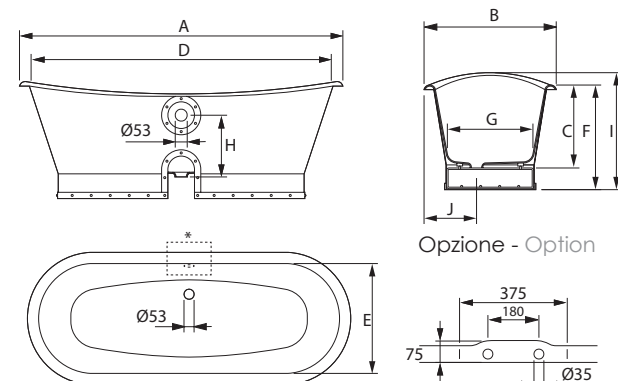

DIMENSIONI - DIMENSIONS (mm)

1700	1700	680	492	1620	585	635	465	390	695	250	-	-	-	-	-	-
A	B	C	D	E	F	G	H	I	J	L	M	N	O	P	Q	R
1700																
KG	LT															
PESO/WEIGHT	VOL.															
198	215															

Antica

Rame
Cuivre
Copper



alluminio satinato
aluminium mat
aluminum matt



Antica

alluminio
aluminium
aluminum

Antica

cuoio
cuir
leather



Tecnico

Valvola di scarico disponibile da 63 mm.

Overflow hole available with 63mm

Misure approssimative - Approximate measurements

INFORMAZIONI TECNICHE - TECHNICAL INFORMATION

DIMENSIONI - DIMENSIONS (mm)

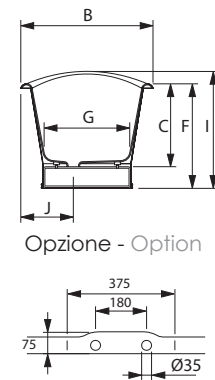
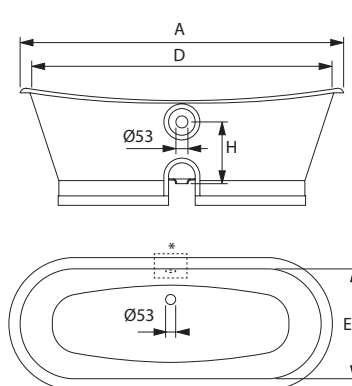

1700	1700	680	492	1620	585	635	465	390	695	250	-	-	-	-	-	-	-	-	-
A	B	C	D	E	F	G	H	I	J	L	M	N	O	P	Q	R			
KG	LT																		
198	215																		

Antica foglia rame
feuille de cuivre
copper foil

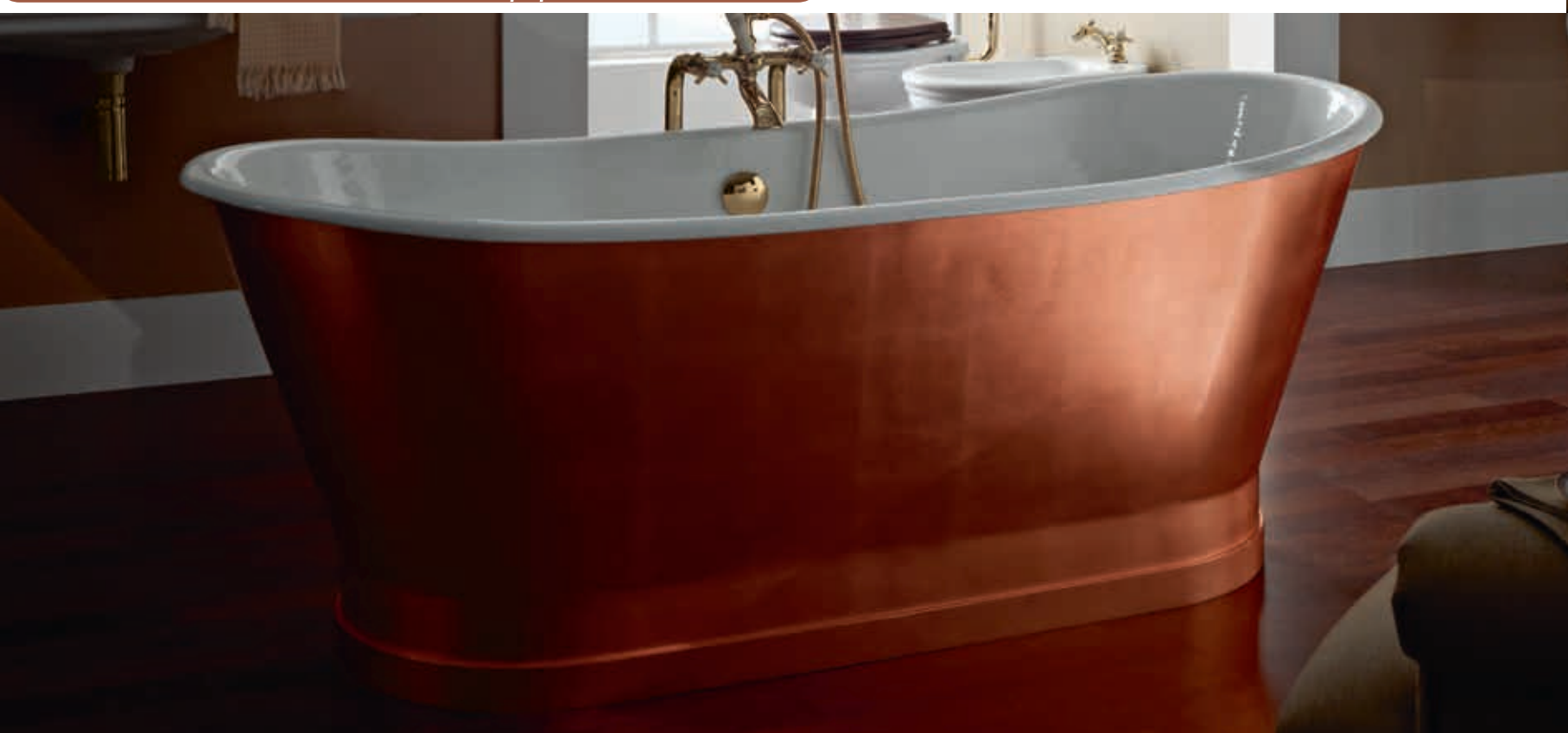

Antica ottone
laiton
brass



Antica Grand colorato
couleur
colour



Tecnico

INFORMAZIONI TECNICHE - TECHNICAL INFORMATION

Valvola di scarico disponibile da 63 mm. Overflow hole available with 63mm Misure approssimative - Approximate measurements

DIMENSIONI - DIMENSIONS (mm)											KG	LT
1770	1770	730	545	1690	635	685	486	475	752	365	PESO/WEIGHT	VOL
A	B	C	D	E	F	G	H	I	J		210	250

Trendy

acciaio
acier
stainless steel



alluminio - aluminium - aluminum



Colette



Tecnico

Valvola di scarico disponibile da 63 mm. Overflow hole available with 63mm Misure approssimative - Approximate measurements

INFORMAZIONI TECNICHE - TECHNICAL INFORMATION

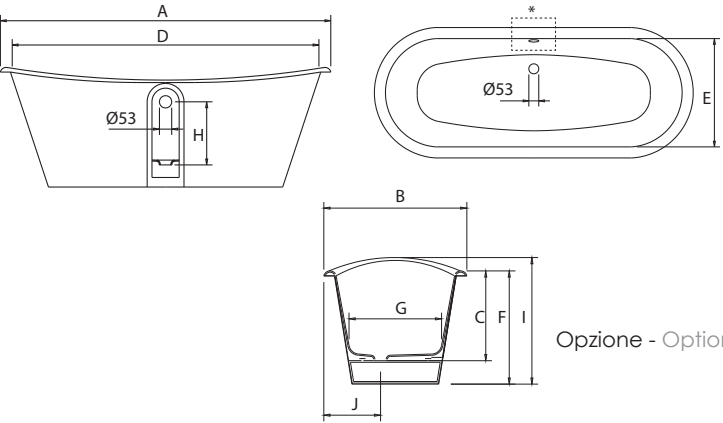

DIMENSIONI - DIMENSIONS (mm)

1700	1700	680	492	1620	585	635	465	390	695	250	-	-	-	-	-	-
	A	B	C	D	E	F	G	H	I	J	L	M	N	O	P	Q

<

Opzione - Option

Tecnico

Valvola di scarico disponibile da 63 mm. Overflow hole available with 63mm Misure approssimative - Approximate measurements

INFORMAZIONI TECNICHE - TECHNICAL INFORMATION

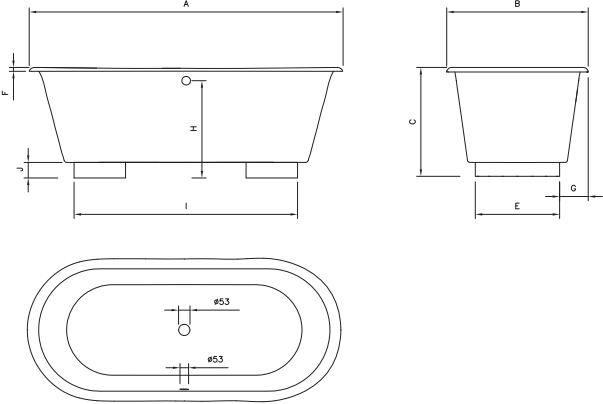

DIMENSIONI - DIMENSIONS (mm)

1712	1712	768	610	463	27	153	530	1220	85	KG	LT
A	B	C	E	F	G	H	I	J		PESO/WEIGHT	VOL.
165		260									

Shabby



Colorato - Couleur - Colour



Charme



Tecnico

Valvola di scarico disponibile da 63 mm. Overflow hole available with 63mm. Misure approssimative - Approximate measurements

INFORMAZIONI TECNICHE - TECHNICAL INFORMATION

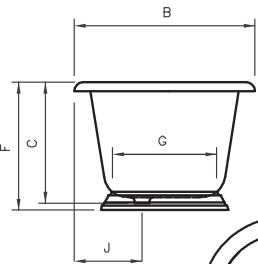
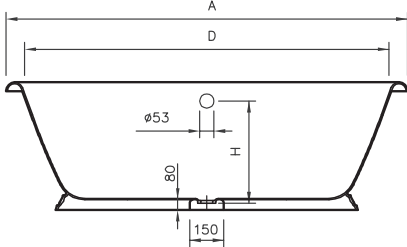

DIMENSIONI - DIMENSIONS (mm)																	1700
A	B	C	D	E	F	G	H	I	J	L	M	N	O	P	Q	R	
1780	1780	800	543	1640	660	585	450	465	-	290	-	-	-	-	-	-	KG 182
																	LT 240

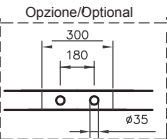

Tecnico

Valvola di scarico disponibile da 63 mm. Overflow hole available with 63mm. Misure approssimative - Approximate measurements

INFORMAZIONI TECNICHE - TECHNICAL INFORMATION

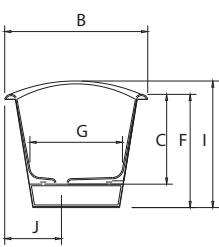
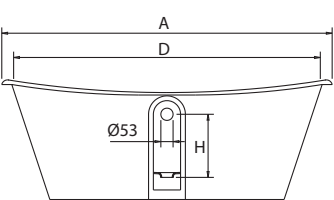

Opzione - Option

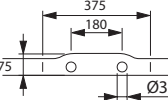

DIMENSIONI - DIMENSIONS (mm)																	1700
A	B	C	D	E	F	G	H	I	J	L	M	N	O	P	Q	R	
1700	1700	680	492	1620	585	635	465	390	695	250	-	-	-	-	-	-	KG 198
																	LT 215

Chic



Pure





Tecnico

Valvola di scarico disponibile da 63 mm.

Overflow hole available with 63mm

Misure approssimative - Approximate measurements

INFORMAZIONI TECNICHE - TECHNICAL INFORMATION

-  Vasca interna in ghisa ed struttura esterna in metallo che si può dipingere in ogni colore.
-  Baignoire en fonte avec structure externe en métal qui peut être peinte de n'importe quelle couleur.
-  Cast iron bath with external metal frame that can be painted in any color.

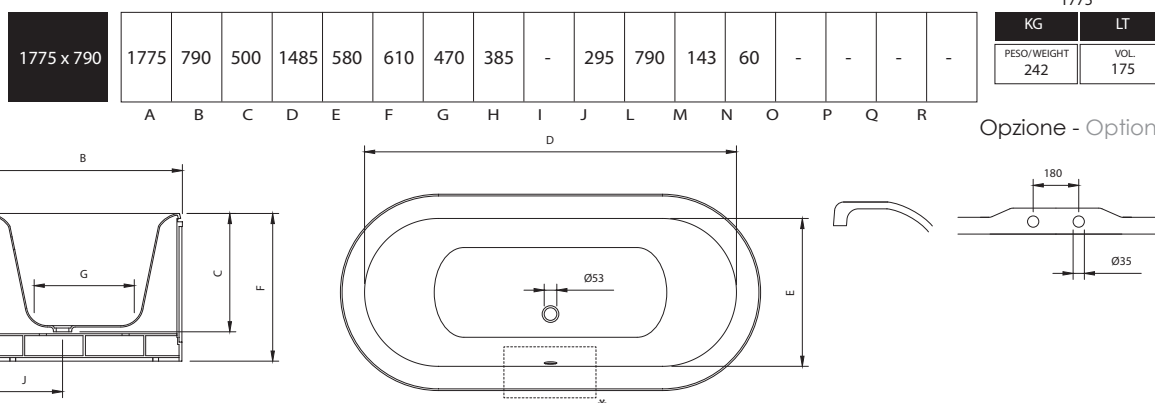

Tecnico

Valvola di scarico disponibile da 63 mm.

Overflow hole available with 63mm

Misure approssimative - Approximate measurements

INFORMAZIONI TECNICHE - TECHNICAL INFORMATION

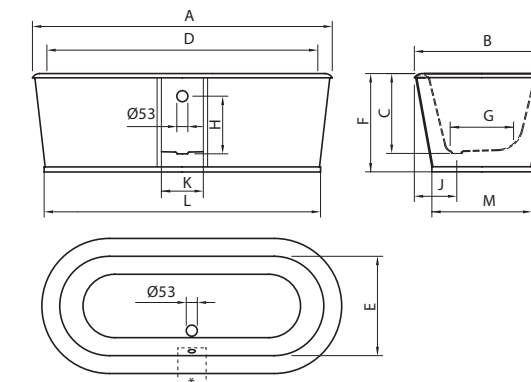

	A	B	C	D	E	F	G	H	I	J	K	L	M			
	1540	780	473	1410	620	585	450	370	-	285	240	1400	590			
	1700	780	475	1560	620	585	450	372	-	275	240	1560	590			

		1540	
		PESO/WEIGHT	VOL
		182	170
		1700	
		PESO/WEIGHT	VOL
		205	190
		1780	
		PESO/WEIGHT	VOL
		246	240

Industrial



Fashion



Tecnico

Valvola di scarico disponibile da 63 mm. Overflow hole available with 63mm Misure approssimative - Approximate measurements

INFORMAZIONI TECNICHE - TECHNICAL INFORMATION

DIMENSIONI - DIMENSIONS (mm)

1700 X 810	1700	810	685	1550	660	472	460	770
	A	B	C	D	E	G	H	J

KG	LT
PESO/WEIGHT 264	VOL. 220

Opzione - Option

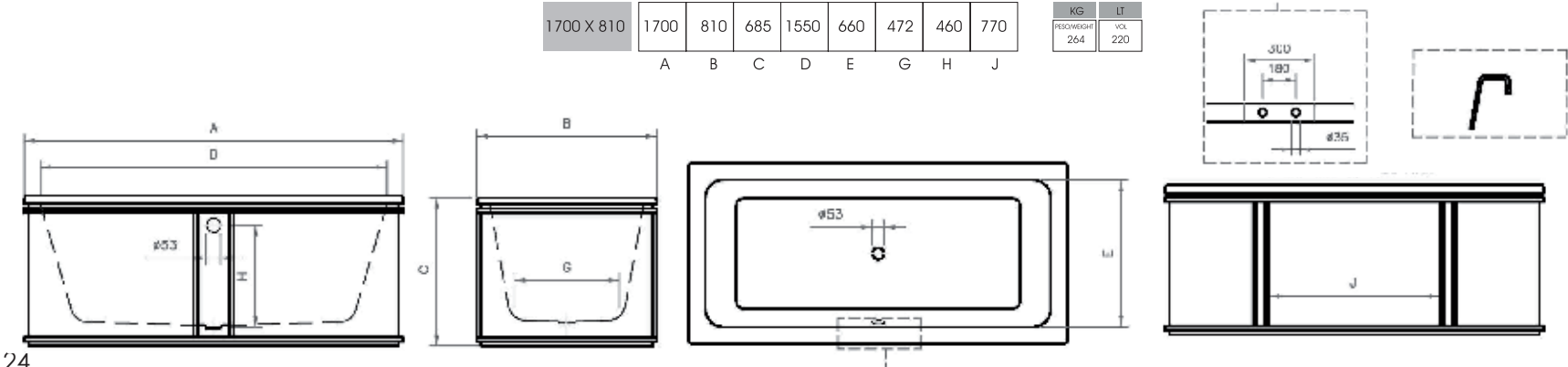

Tecnico

Valvola di scarico disponibile da 63 mm. Overflow hole available with 63mm Misure approssimative - Approximate measurements

INFORMAZIONI TECNICHE - TECHNICAL INFORMATION

DIMENSIONI - DIMENSIONS (mm)

DIMENSIONI - DIMENSIONS (mm)										KG	LT
1370	1370	765	455	1240	615	610	363	290	140	PESO/WEIGHT 185	VOL. 175
1540	1540	770	470	1400	615	610	383	290	140	203	200
1700	1700	775	473	1580	615	610	390	290	140	215	225
1770	1770	765	490	1615	610	610	430	260	140	218	250
	A	B	C	D	E	F	H	J	L		

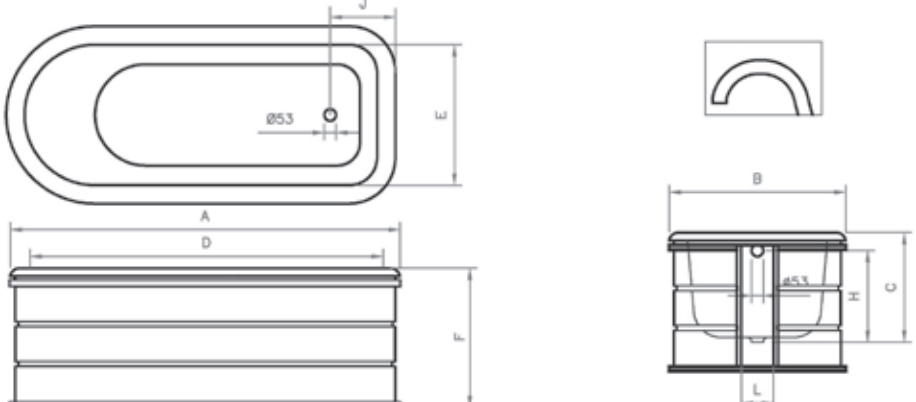

Ginger



Other Finishes

Autres finitions
Altre finiture



Mosaic



Mosaic

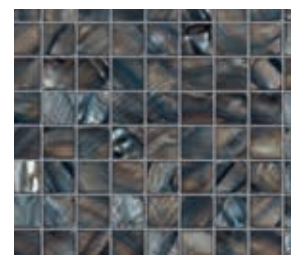

Mosaico 1

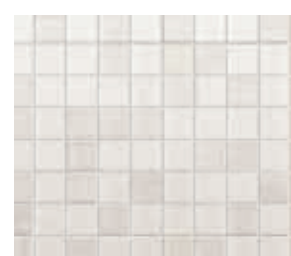

Mosaico 2



Mosaico 3

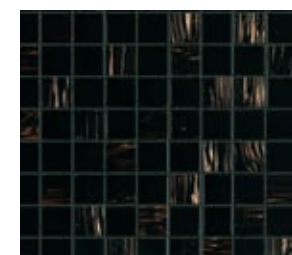

Mosaico 4

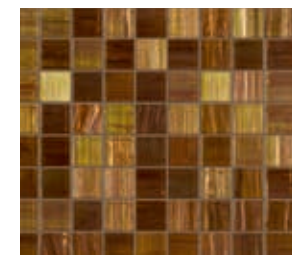

Mosaico 5

Tecnico

INFORMAZIONI TECNICHE - TECHNICAL INFORMATION

Valvola di scarico disponibile da 63 mm.

Overflow hole available with 63mm

Misure approssimative - Approximate measurements

DIMENSIONI - DIMENSIONS (mm)										KG	LT
										PESO/WEIGHT	VOL
1700	1700	810	562	1550	660	686	480	460	405	235	220
A	B	C	D	E	F	G	H	J			

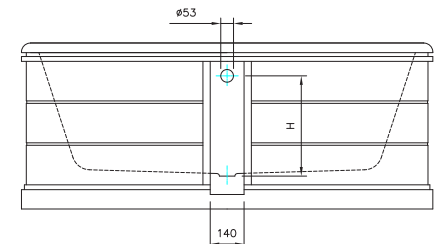
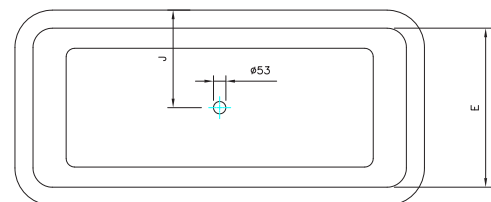
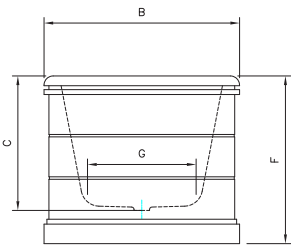
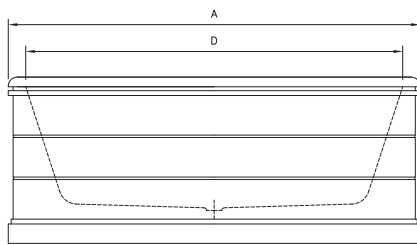

- 🇮🇹 Foglie d'oro, argento o rame
- 🇫🇷 Feuilles d'or, d'argent ou de cuivre
- 🇬🇧 Golden leaf; silver leaf; copper leaf



Gold LEAF
Silver LEAF
Copper LEAF

Dare to colour...

Osez la couleur... Osate il colore !!!

🇮🇹 Qualsiasi colore RAL e NCS è possibile su ogni vasca ... sta a voi decidere!

🇫🇷 Couleurs et nuances RAL et NCS tout est possible sur chacune des baignoires...à vous de choisir !

🇬🇧 Colours and shades RAL and NCS everything is possible on every bathtub...it is up to you to choose!



Piedini in dettaglio



Piede Lavande



Piede Romarin

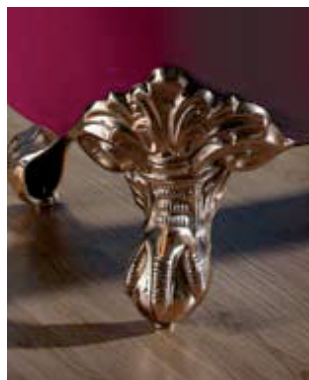

Piede Vintage



Piede Jasmine



Piede Anis



Piede Fleur

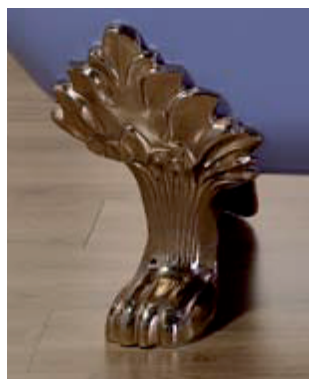

Piede Lion

Finitura piedi • Finitions • Finishes



Cromo • Chromé • Chrome



Bianco • Blanc • White

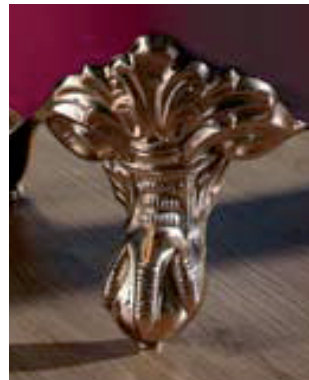

Oro • Or • Gold

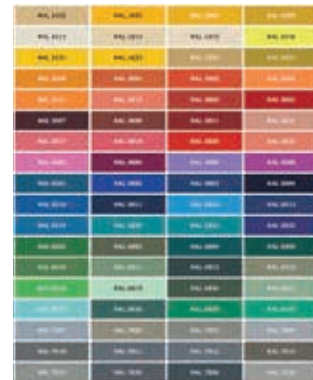

Colore RAL • Couleur RAL
Colour RAL

Tutti i Piedi sono in ghisa
Tous les Pieds sont en fonte
All the feet are in cast iron

Accessoires baignoires
Accessori vasche

Bath Accessories

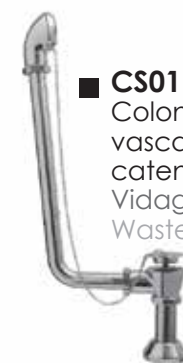

■ **CS01**
Colonna scarico
vasca esterna con
catenella
Vidage avec chainette
Waste with chain



■ **CS02**
Colonna scarico
vasca esterna
automatica
Vidage automatique
Automatic waste



■ **CS03**
Colonna scarico
vasca incasso
automatica
Vidage baignoire à
encastrer
Waste for recessed
bath-tubs



■ **SIF01**
Sifone scarico
vasca
Siphon
Syphon



■ **PT80**
Tubolare ten-
da da soffitto
cm.80
Porte rideau
Shower rail

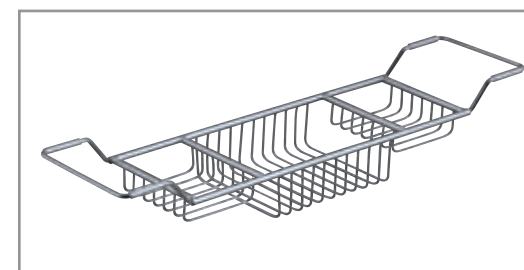

■ **PS01** • Porta sapone da appoggio
vasca cm.50/75
Barre porte savon cm.50/75
Bath rack cm.50/75

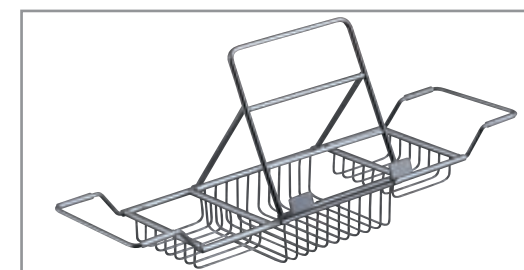

■ **PS01.2** • Porta sapone da appoggio
vasca cm.50/75 + leggito da vasca
Barre porte savon cm.50/75 + porte livre
Bath rack cm.50/75 + bathtub book holder



■ **AB226** • Leggio da vasca
(da associare con articolo PS01)
Porte livre de baignoire
(convient avec l'article PS01)
Bathtub book holder
(to associate with item PS01)

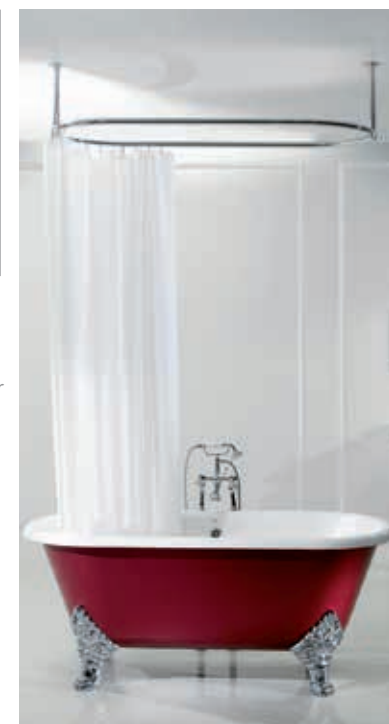

■ **PT110**
Tubolare ten-
da da soffitto
cm.110
Porte rideau
Shower rail

■ **PT156**
Tubolare ten-
da da soffitto
cm.156
Porte rideau
Shower rail

Misure disponibili: cm.800x640 - cm.1100x640 - cm.1560x640

Specifiche tecniche vasche • Spécifications techniques baignoires • Bath technical specifications

- Tutte le nostre Vasche sono in ghisa piena, con interno smaltato bianco al titanio. Le nostre Vasche in ghisa rispettano gli standard qualitativi usando soltanto smalto classe AA, ASME A112-19.1-2008, CSA B45.2-08, EN-BS 232:2003, EN-BS 14516:2006 a norma CEE.
Finitura esterna vasche: Ghisa grezza, Ghisa con base primer, Bianco, Colore RAL o NCS sia opaco che lucido, Colori metallizzati, Mosaico.
Finitura piedi: Ghisa grezza, Ghisa con base primer, Bianco, Colore RAL o NCS sia opaco che lucido, Colori metallizzati, Cromo, Nickel spazzolato, Ottone lucido.
- Toutes nos baignoires sont en fonte pleine avec intérieur émaillé blanc au titane. Nos baignoires respectent tous les standards de qualité requis des classes AA, ASME A112-19.1-2008, CSA B45.2-08, EN-BS 232:2003, EN-BS 14516:2006 a norme CEE
Finitions extérieures des baignoires: Fonte brute, fonte avec base, fonte avec couleur blanche ou toutes couleurs à base RAL ou NCS (qu'elles soient mates, brillantes ou métallisées), mosaïc.
Finition des pieds: Fonte brute, fonte avec base, fonte avec couleur blanche ou toutes couleurs à base RAL ou NCS (qu'elles soient mates, brillantes ou métallisées). Chrome, nickel ou laiton.
- All our bathtubs are full cast iron with titanium white enameled interiors. Our bathtubs meet all quality standards required classes AA, ASME A112-19.1-2008, CSA B45.2-08, BS-EN 232:2003, BS EN 14516:2006, standard EEC
Exterior finishes of the bathtubs: Raw cast iron, base cast iron, cast iron with white or any color based RAL or NCS (both matt, shiny or metalized), mosaic.
Feet finishes: Raw cast iron, base cast iron, cast with white or any color based RAL or NCS (both matt, shiny or metalized). Chromium, nickel or brass.

Recessed cast iron bathtubs

 Baignoires en fonte à encastrer
 Vasche ghisa ad incasso

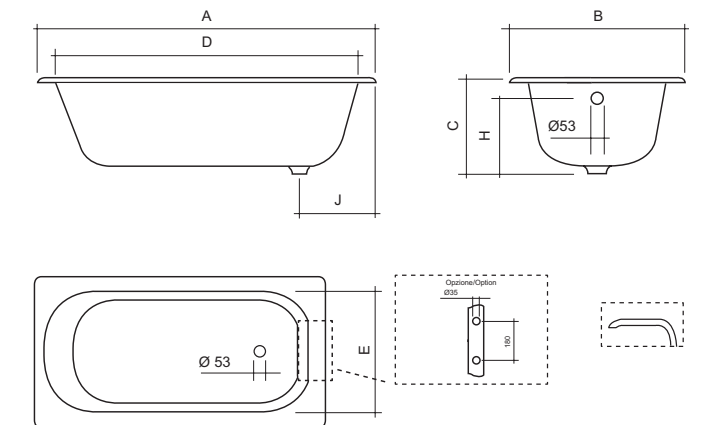
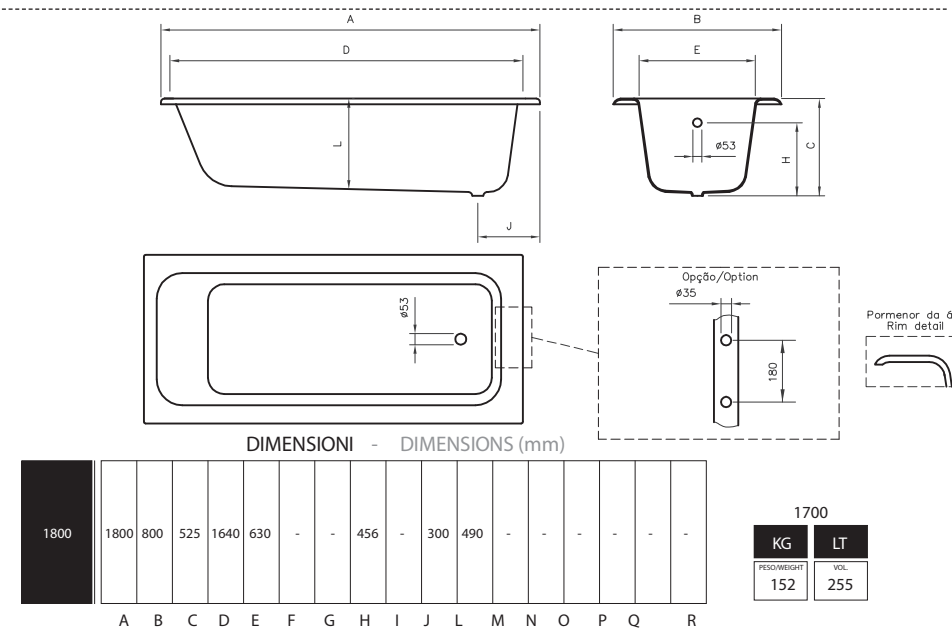
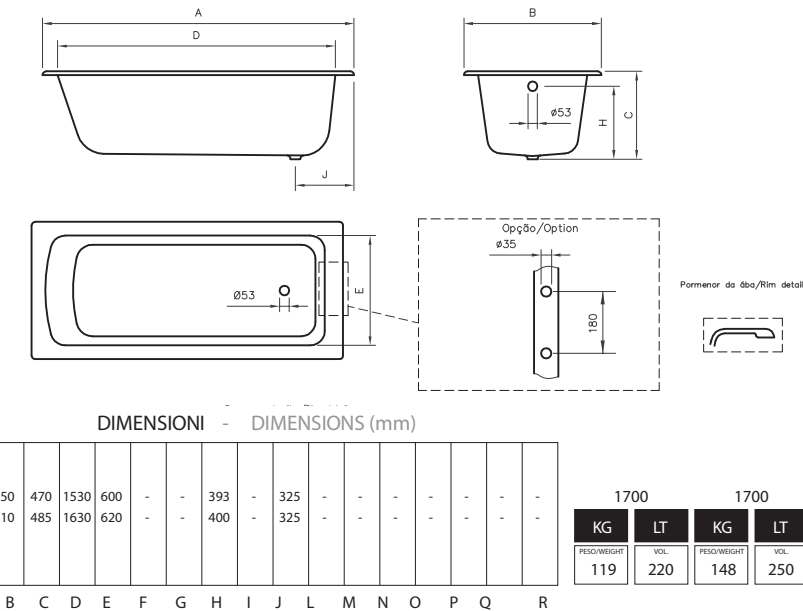

DIMENSIONI IN MILLIMETRI										
REF.	A	B	C	D	E	H	J	VOL.	PESO	
1200	1200	700	420	1320	560	350	320	100L	84KG	
1400	1400	700	420	1320	560	350	320	130L	88KG	
1500	1500	700	420	1320	560	350	320	145L	102KG	
1600	1600	700	420	1420	560	350	320	160L	112KG	
1700	1700	700	420	1520	560	350	320	175L	117KG	

Recessed cast iron bathtubs

 Baignoires en fonte à encastrer
 Vasche ghisa ad incasso



Baignoires en fonte à encastrer 
Vasche ghisa ad incasso 

Recessed cast iron bathtubs

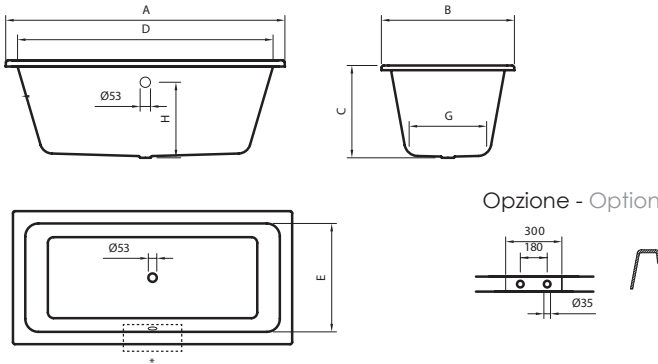

DIMENSIONI - DIMENSIONS (mm)																
1700	1700	810	562	1550	660	-	472	460	-	-	-	-	-	-	-	-
	A	B	C	D	E	F	G	H	I	J	L	M	N	O	P	Q

1700	
KG	LT
PESO/WEIGHT	VOL.
128	220

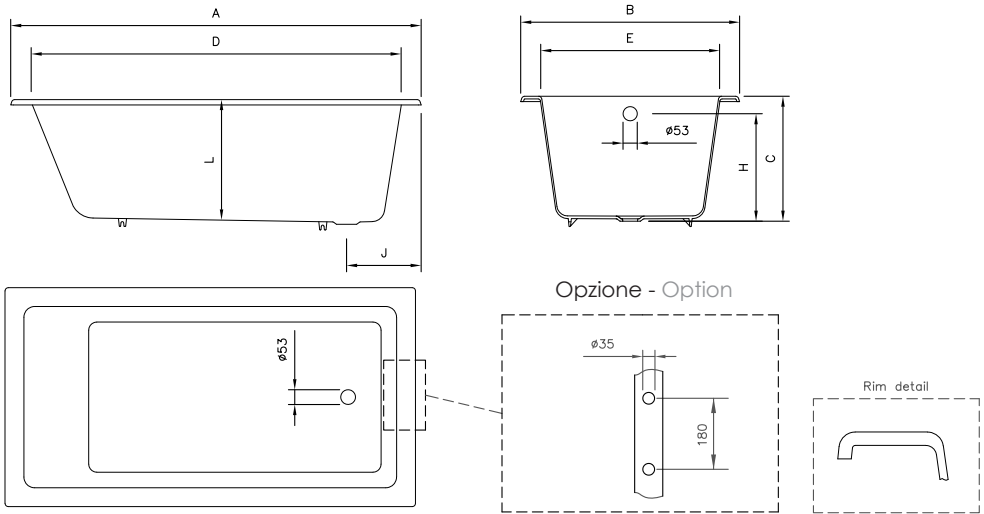

DIMENSIONI - DIMENSIONS (mm)									KG	LT
1524	1524	810	470	1384	670	405	270	450	PESO/WEIGHT	VOL.
	A	B	C	D	E	H	J	L	128	180

Taps

Robinets
Rubinetti



CROMO
CHROME
CHROME



NICHEL
NICKEL
NICKEL

Tutti i rubinetti possono avere una qualsiasi delle maniglie sottostanti e sono disponibili nelle finiture elencate nell'ultima pagina.
Tous les robinets peuvent avoir l'une des poignées ci-dessous et sont disponibles dans les finitions répertoriées sur la dernière page.
All taps can have any of the handles below and are available in the finishes as listed on last page.

Tap Handles

Poignées
Manopole



PASTIGLIE - PASTILLES POUR POIGNÉES - LOZENGES FOR HANDLES



Gli ordini vengono evasi automaticamente con pastiglia 1, gli altri tipi sono da specificare al momento dell'ordine. Les commandes sont livrées par défaut avec les pastilles n°1.
Les autres pastilles sont disponibles sur demande. Orders are delivered with Lozenges n°1 by default. All other lozenges are available upon request.

Tap Handles Poignées Manopole

N.B. I colori delle manopole Porcellaine sono indicativi
N.B. Les couleurs des poignées Porcelaine sont purement indicatives
N.B. Colors of the Porcelaine handles are purely indicative

ANIS



CERAMICA BIANCA - CÉRAMIQUE BLANC
WHITE CERAMIC



CERAMICA NERA - CÉRAMIQUE NOIRE
BLACK CERAMIC



LEGNO ULIVO NATURALE
BOIS D'OLIVIER NATUREL - NATURAL OLIVE WOOD



LEGNO RADICA
BOIS RONCE - BURL WOOD



ANIS DECOR



METALLO
MÉTAL - METAL

FINITURE - FINITIONS - FINISHES

VINTAGE



CERAMICA BIANCA - CÉRAMIQUE BLANC
WHITE CERAMIC



CERAMICA NERA - CÉRAMIQUE NOIRE
BLACK CERAMIC



ANTICATA
CRAQUELÉ ANCIEN - OLD CRACKED

FINITURE - FINITIONS - FINISHES

PORCELAINE



CERAMICA ROSA
CÉRAMIQUE ROSE
PINK CERAMIC



CERAMICA GIALLA
CÉRAMIQUE JAUNE
YELLOW CERAMIC



CERAMICA NERO / NERO MATE
CÉRAMIQUE NOIRE MATE
MATT BLACK CERAMIC



CERAMICA VERDE
CÉRAMIQUE VERTE
GREEN CERAMIC



CERAMICA AZZURRA
CÉRAMIQUE BLEUE
BLUE CERAMIC



CERAMICA ROSSA
CÉRAMIQUE ROUGE
RED CERAMIC

FINITURE - FINITIONS - FINISHES

Taps Robinets Rubinetti

NICHEL MAT
NICKEL MAT
MATTE NICKEL



OTTONE NATURALE
LAITON NATUREL
NATURAL BRASS



3 holes basin Taps

🇫🇷 Robinets pour lavabo 3 trous

🇮🇹 Rubinetti per lavabo 3 fori



■ **RLA101** • Batteria lavabo 3 fori collo alto manopole Anis
Robinet haut 3 trous poignées Anis
3 holes high neck set ANIS



■ **RLC102** • Batteria lavabo 3 fori collo basso CROIX
Robinet bas lavabo 3 trous CROIX
3 holes basin set CROIX



■ **RLO103** • Rubinetto 3 fori collo alto manopole Olive
Robinet haut lavabo 3 trous poignées Olive
3 holes set Olive handles



■ **RLSF500** • Rubinetto 3 fori SO FIFTIES
Robinet 3 trous SO FIFTIES
3 holes tap SO FIFTIES



■ **RLCS401** • Rubinetto 3 fori collo alto manopole Cross
Robinet haut 3 trous poignées Cross
3 holes high neck tap Cross handles



■ **RLSH402** • Rubinetto 3 fori collo alto manopole Shine
Robinet haut 3 trous poignées Shine
3 holes high neck tap Shine handles



■ **RLL202** • Batteria lavabo 3 fori collo basso LUX
Robinet bas lavabo 3 trous LUX
3 holes basin set LUX



■ **RLMT301** • Batteria lavabo 3 fori METROPOLITAN
Robinet 3 trous industriel Metropolitan
3 holes industrial tap Metropolitan



■ **RLCH1031** • Rubinetto 3 fori collo basso manopole Charme
Robinet bas 3 trous poignées Charme
3 holes set Charme handles

NB. Tutti i modelli dei rubinetti sono disponibili con qualsiasi manopola vedi pag. 37 (vi preghiamo precisare sugli ordini modello manopola scelta insieme al codice rubinetto).
NB. Tous les modèles de robinets sont disponibles avec n'importe laquelle de nos poignées (voir page 37). Nous vous invitons, lors de votre commande, à nous préciser outre le code du robinet, le modèle de poignée souhaité. - NB. All the taps are available with any of our top handles (see page 37).
Please, when ordering, make sure to precise the model of the handle you want in addition to the code of the tap.

Taps Robinets Rubinetti

ORO CHIARO
OR CLAIR
LIGHT GOLD



ORO SCURO
OR FONCE
DARK GOLD



2 holes basin Taps

🇫🇷 Robinets pour lavabo 2 trous

🇮🇹 Rubinetti per lavabo 2 fori



■ **RLF1013** • Rubinetto ponte piccolo 2 fori FLEUR interasse cm.20
Robinet pont bas lavabo 2 trous FLEUR interaxe cm.20
Low bridge tap 2 holes basin set FLEUR cm.20



■ **RLP1014P** • Rubinetto ponte 2 fori PORCELAINE
Robinet pont haut lavabo 2 trous PORCELAINE
High bridge tap 2 holes basin set PORCELAINE



■ **RLP1014.2** • Rubinetto ponte 2 fori manopole Marguerite
Robinet pont haut lavabo 2 trous poignées MARGUERITE
High bridge tap 2 holes bridge mixer tap MARGUERITE



■ **RLMT314** • Rubinetto ponte lavabo 2 fori manopole Metropolitan
Robinet 2 trous industriel poignées Metropolitan
Industrial 2 holes bridge tap Metropolitan handles



■ **RLA1018** • Rubinetto ponte lavabo 2 fori ANIS
Robinet 2 trous ANIS
2 holes tap ANIS



■ **RLA1019** • Rubinetto ponte lavabo 2 fori MARGUERITE
Robinet 2 trous MARGUERITE
2 holes tap MARGUERITE



■ **RLMTM314.2** • Rubinetto 2 fori freestanding manopole Metropolitan
Robinet 2 trous sur pieds poignées Metropolitan
2 holes freestanding tap Metropolitan handles

Taps Robinets Rubinetti



ORO ROSA
OR ROSE
GOLD PINK



ORO MAT
OR MAT
MATTE GOLD

1 hole basin Taps

 Robinets pour lavabo 1 trou
 Rubinetti per lavabo 1 foro



RLC1042 • Monoforo lavabo CROIX
 Monotrou lavabo CROIX
 1 hole basin set CROIX



RLF104 • Monoforo lavabo FLEUR
 Monotrou lavabo FLEUR
 1 hole basin set FLEUR



RLC1043 • Monoforo lavabo CROIX
 Monotrou lavabo CROIX
 1 hole basin set CROIX



RLA1044 • Miscelatore 1 foro ANIS
 Robinet mitigeur 1 trou ANIS
 Mixer 1 hole ANIS



RLL204 • Miscelatore 1 foro LUX
 Robinet mitigeur 1 trou LUX
 Mixer 1 hole LUX



RLA1044.2 • Miscelatore 1 foro ANIS
 Robinet mitigeur 1 trou ANIS
 Mixer 1 hole ANIS



RLF100 • Rubinetto singolo FLEUR
 Robinet bas simple FLEUR
 FLEUR low single tap



RLA1024 • Miscelatore 1 foro ANIS
 Robinet mitigeur 1 trou ANIS
 Mixer 1 hole tap ANIS



RLA1044.1 • Miscelatore 1 foro manopola Anis
 Robinet mitigeur 1 trou poignée ANIS
 Mixer 1 hole ANIS handle

* short spout

NB. Tutti i modelli dei rubinetti sono disponibili con qualsiasi manopola vedi pag. 37 (vi preghiamo precisare sugli ordini modello manopola scelta insieme al codice rubinetto).
 NB. Tous les modèles de robinets sont disponibles avec n'importe laquelle de nos poignées (voir page 37). Nous vous invitons, lors de votre commande, à nous préciser outre le code du robinet, le modèle de poignée souhaité. - NB. All the taps are available with any of our top handles (see page 37).
 Please, when ordering, make sure to precise the model of the handle you want in addition to the code of the tap.

Taps Robinets Rubinetti

RAME ANTICO
 CUIVRE ANCIEN
 OLD COPPER



RAME
 CUIVRE
 COPPER

Wall mounted basin Taps

Robinets muraux pour lavabo

Rubinetti murali per lavabo



■ **RLC1011M** • Rubinetto murale 3 fori CROIX
Robinet mural 3 trous CROIX
Wall mounted tap 3 holes CROIX



■ **RLM1012** • Rubinetto murale 3 fori MARGUERITE
Robinet mural 3 trous MARGUERITE
Wall mounted tap 3 holes MARGUERITE



■ **RLF1012D** • Rubinetto murale 3 fori FLEUR
Robinet mural 3 trous FLEUR
Wall mounted tap 3 holes FLEUR



■ **RLC1015M** • Rubinetto murale scatolato 3 fori CROIX cm.43xh12
Robinet mural 3 trous CROIX cm.43xh12
Wall mounted tap 3 holes with CROIX handles cm.43xh12



■ **RLF1016M** • Rubinetto murale 3 fori con placca FLEUR
Robinet mural 3 trous FLEUR
Wall mounted Tap 3 holes FLEUR



■ **RLC1018M** • Rubinetto murale 3 fori con placca
Robinet mural 3 trous
Wall mounted Tap 3 holes



■ **RLA1022**
Miscelatore lavabo ANIS
Mitigeur lavabo ANIS
Washbasin mixer ANIS



■ **RLC1023**
Rubinetto monoforo 2 manopole Croix
Robinet mélangeur monotrou 2 poignées Croix
Single tap with 2 Croix handles



■ **RLL2011**
Rubinetto 3 fori bocca dritta LUX
Robinet droit 3 trous LUX
3 holes set straight spout LUX



■ **RLT1017M** • Rubinetto murale 3 fori TRIA
Robinet mural 3 trous TRIA
Wall mounted tap 3 holes TRIA

NB. Tutti i modelli dei rubinetti sono disponibili con qualsiasi manopola vedi pag. 37 (vi preghiamo precisare sugli ordini modello manopola scelta insieme al codice rubinetto).
NB. Tous les modèles de robinets sont disponibles avec n'importe laquelle de nos poignées (voir page 37). Nous vous invitons, lors de votre commande, à nous préciser outre le code du robinet, le modèle de poignée souhaité. - NB. All the taps are available with any of our top handles (see page 37).
Please, when ordering, make sure to precise the model of the handle you want in addition to the code of the tap.

Taps Robinets Rubinetti

COLORI RAL
COULEURS RAL
RAL COLOURS



NICHEL NERO
NICKEL NOIR
BLACK NICKEL



Wall mounted basin Taps

 Robinets muraux pour lavabo
 Rubinetti murali per lavabo



■ **RLF100M** • Rubinetto con erogazione da muro manopola Fleur
Robinet mural poignée Fleur
Wall mounted tap Fleur handle



■ **RLA1012.1**
Rubinetto murale miscelatore 3 fori manopola ANIS
Robinet mural mitigeur 3 trous poignée ANIS
Wall mounted mixer tap 3 holes ANIS handle



■ **RLA03.2**
Rubinetto murale miscelatore 2 fori ANIS
Robinet mural mitigeur 2 trous ANIS
Wall mounted mixer tap 2 holes ANIS



■ **RLMTM3012D** • Rubinetto murale 3 fori MARGUERITE
Robinet mural 3 trous MARGUERITE
Wall mounted tap 3 holes MARGUERITE



■ **RLA1022.1**
Miscelatore lavabo manopola ANIS
Mitigeur lavabo poignée ANIS
Washbasin mixer ANIS handle

Taps Accessories

 Accessori per rubinetteria
 Accessoire pour robinetterie



■ **RLSIF** • Sifone lavabo
Siphon pour lavabo
Washbasin siphon



■ **RBSIF** • Sifone Bidet
Siphon pour bidet
Washbasin siphon



■ **Pilo1**
Piletta Clic-Clac
Bonde clic-clac
Clic-clac waste



■ **Pilo1CER** • Piletta Clic-Clac in ceramica
Bonde clic-clac céramique - Clic-clac waste in ceramic



■ **RFil01** • Rubinetto sottolavabo con filtro
Robinet d'arrêt sous lavabo
Under basin tap with filter

Robinets pour bidet 1 trou 
 Rubinetti per bidet 1 foro 

1 hole bidet Taps



■ **RBF105** • Monoforo bidet FLEUR
Monotrou mélangeur bidet FLEUR
1 hole bidet set FLEUR



■ **RBF1053** • Monoforo bidet FLEUR
Monotrou mélangeur bidet FLEUR
1 hole bidet set FLEUR



■ **RBA1074** • Miscelatore 1 foro ANIS
Robinet mitigeur 1 trou ANIS
Mixer 1 hole ANIS



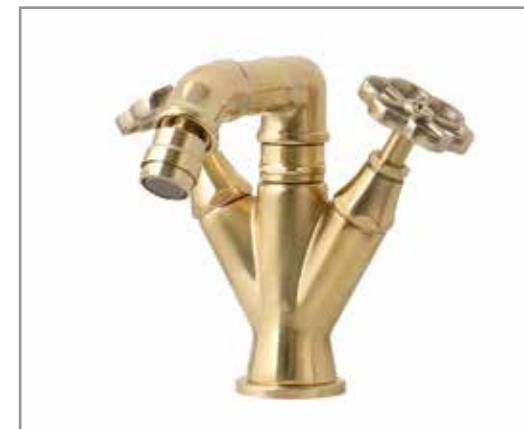

■ **RBL205** • Monoforo bidet LUX
Monotrou mélangeur bidet LUX
1 hole bidet set LUX



■ **RBMTM305** • Monoforo bidet Industriale
Monotrou mélangeur bidet industriel
1 hole industrial bidet set



■ **RBA1025** • Miscelatore bidet ANIS
Mitigeur pour bidet ANIS
Bidet mixer ANIS

Robinets pour bidet 3 trous 
 Rubinetti per bidet 3 trous 

3 holes bidet Taps



■ **RBF106** • Batteria bidet FLEUR 3 fori senza erogazione
Robinets bidet FLEUR 3 trous sans bec verseur
Bidet FLEUR tap 3 holes without spout



■ **RBO107** • Batteria bidet 3 fori collo basso OLIVE
Robinet bas bidet 3 trous OLIVE
3 holes bidet set OLIVE



■ **RBC108** • Batteria bidet 3 fori collo alto CROIX
Robinet haut bidet 3 trous CROIX
3 holes bidet set CROIX

NB. Tutti i modelli dei rubinetti sono disponibili con qualsiasi manopola vedi pag. 37 (vi preghiamo precisare sugli ordini modello manopola scelta insieme al codice rubinetto).
NB. Tous les modèles de robinets sont disponibles avec n'importe laquelle de nos poignées (voir page 37). Nous vous invitons, lors de votre commande, à nous préciser outre le code du robinet, le modèle de poignée souhaité. - NB. All the taps are available with any of our top handles (see page 37).
Please, when ordering, make sure to precise the model of the handle you want in addition to the code of the tap.

NB. Tutti i modelli dei rubinetti sono disponibili con qualsiasi manopola vedi pag. 37 (vi preghiamo precisare sugli ordini modello manopola scelta insieme al codice rubinetto).
NB. Tous les modèles de robinets sont disponibles avec n'importe laquelle de nos poignées (voir page 37). Nous vous invitons, lors de votre commande, à nous préciser outre le code du robinet, le modèle de poignée souhaité. - NB. All the taps are available with any of our top handles (see page 37).
Please, when ordering, make sure to precise the model of the handle you want in addition to the code of the tap.

3 holes bidet Taps

 Robinets pour bidet 3 trous
 Rubinetti per bidet 3 trous



■ **RBMT307** • Bateria bidet 3 fori METROPOLITAN
 Robinet bidet 3 trous industriel Metropolitan
 3 holes industrial bidet tap Metropolitan



■ **RBL207** • Bateria bidet 3 fori LUX
 Robinet bidet 3 trous LUX
 Bidet tap 3 holes set LUX



■ **RBF1081** • Bateria bidet 3 fori collo basso FLEUR
 Robinet bidet 3 trous col bas FLEUR
 Low bidet tap 3 holes set FLEUR





■ **RBSF505** • Rubinetto bidet 3 fori SO FIFTIES
 Robinet bidet 3 trous SO FIFTIES
 3 holes bidet tap SO FIFTIES



■ **RBCS407** • Rubinetto bidet 3 fori manopole Cross
 Robinet bidet 3 trous poignées Cross
 3 holes bidet tap manopole Cross

Kitchen Taps

 Robinets pour salle de bain et cuisine
 Rubinetti per bagno e cucina

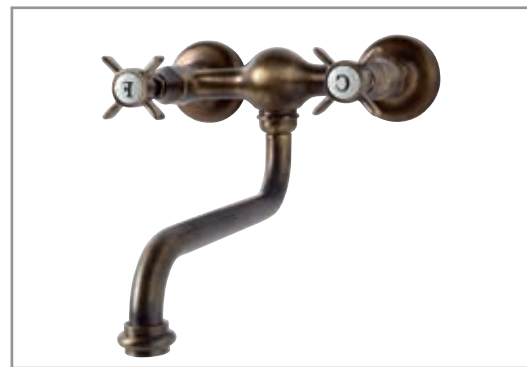

■ **RKF01** • Gruppo a muro con collo snodabile manopole FLEUR
 Robinet mural 2 trous poignées FLEUR
 Wall mounted 2 holes tap with FLEUR handles



■ **RKO02** • Monoforo a muro con collo snodabile OLIVE
 Robinet mural monotrou OLIVE
 Wall mounted tap single hole with OLIVE handles



■ **RKA03** • Miscelatore a muro con bocca distaccata ANIS
 Mitigeur mural 2 trous ANIS
 Wall mounted 2 holes mixer tap with ANIS handles

NB. Tutti i modelli dei rubinetti sono disponibili con qualsiasi manopola vedi pag. 37 (vi preghiamo precisare sugli ordini modello manopola scelta insieme al codice rubinetto).
 NB. Tous les modèles de robinets sont disponibles avec n'importe laquelle de nos poignées (voir page 37). Nous vous invitons, lors de votre commande, à nous préciser outre le code du robinet, le modèle de poignée souhaité. - NB. All the taps are available with any of our top handles (see page 37).
 Please, when ordering, make sure to precise the model of the handle you want in addition to the code of the tap.

Taps Robinets Rubinetti

BRONZO SCURO
 BRONZE FONCE
 DARK BRONZE



BRONZO CHIARO
 BRONZE CLAIR
 LIGHT BRONZE



CORTEN
 CORTEN
 CORTEN



Kitchen Taps

Robinets pour salle de bain et cuisine
Rubinetti per bagno e cucina



■ **RKA04** • Batteria murale tre fori con bocca girevole manopole Anis
Robinet mélangeur mural 3 trous avec col tournant poignées Anis
Wall mounted three holes mixer tap with swivel spout Anis handles



■ **RKA05** • Monoforo lavabo con doccia estraibile ANIS
Robinet monotrou avec bouche extractible ANIS
One hole tap with extractable mouth in with ANIS handle



■ **RKA06** • Gruppo a muro con bocca alta girevole ANIS
Robinet mitigeur mural 2 trous ANIS
Wall mounted mixer tap 2 holes with ANIS handle



■ **RKA07** • Rubinetto con erogazione da muro ANIS
Robinet mural ANIS
Wall mounted tap with ANIS handle



■ **RKM08** • Monoforo lavello con bocca girevole manopole Marguerite
Robinet mélangeur monotrou avec col haut tournant poignées Marguerite
One hole mixer tap with swivel spout Marguerite handles



■ **RKM09** • Rubinetto due fori lavello con bocca girevole manopole Marguerite
Robinet mélangeur 3 trous avec col tournant poignées Marguerite
Three holes mixer tap with swivel spout Marguerite handles



■ **RKM10** • Batteria quattro fori lavello con bocca girevole e doccia estraibile manopole Marguerite
Robinet mélangeur 4 trous avec douchette extractible poignées Marguerite
Four holes mixer tap with pull out handset Marguerite handles



■ **RKF11** • Rubinetto due fori lavello con bocca girevole manopole Fleur
Robinet mélangeur 2 trous avec col tournant poignées Fleur
Two holes mixer tap with swivel spout Fleur handles



■ **RKC12** • Rubinetto due fori lavello con bocca girevole manopole Croix
Robinet mélangeur 2 trous avec col tournant poignées Croix
Two holes mixer tap with swivel spout Croix handles

NB. Tutti i modelli dei rubinetti sono disponibili con qualsiasi manopola vedi pag. 37 (vi preghiamo precisare sugli ordini modello manopola scelta insieme al codice rubinetto).
NB. Tous les modèles de robinets sont disponibles avec n'importe laquelle de nos poignées (voir page 37). Nous vous invitons, lors de votre commande, à nous préciser outre le code du robinet, le modèle de poignée souhaité. - NB. All the taps are available with any of our top handles (see page 37).
Please, when ordering, make sure to precise the model of the handle you want in addition to the code of the tap.

Robinets pour salle de bain et cuisine
Rubinetti per bagno e cucina

Kitchen Taps



■ **RKM13** • Rubinetto a muro due fori con bocca fissa manopole Marguerite
Robinet mural mélangeur 2 trous poignées Marguerite
Wall mounted 2 holes mixer tap Marguerite handles

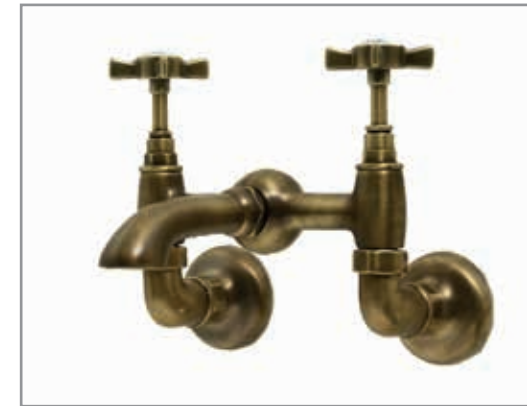

■ **RKF14** • Rubinetto a muro due fori bocca fissa manopole Fleur
Robinet mélangeur mural 2 trous poignées Fleur
Wall mounted two holes mixer tap Fleur handles



■ **RKC15** • Rubinetto a muro due fori bocca girevole manopole Croix
Robinet mélangeur mural 2 trous avec col tournant poignées Croix
Wall mounted tap 2 holes with swivel spout Croix handles



■ **RKMT16** • Monoforo lavello con bocca girevole manopole Metropolitan
Robinet mélangeur monotrou tournant col haut poignées Metropolitan
One hole revolving mixer tap Metropolitan handles



■ **RKA17** • Miscelatore a muro due fori bocca girevole manopola Anis
Robinet mitigeur mural 2 trous avec col tournant poignée Anis
Robinet Wall mounted mixer tap 2 holes with swivel spout Anis handle



■ **RKMT18** • Miscelatore lavello bocca girevole manopola Metropolitan
Robinet mitigeur monotrou tournant col haut poignée Metropolitan
One hole revolving mixer tap Metropolitan handle



■ **RKMT19** • Rubinetto Metropolitan murale tre fori con placca
Robinet mélangeur mural trois trous Metropolitan
Wall mounted mixer tap Metropolitan 3 holes





■ **RKM20CR** • Rubinetto 2 fori bocca girevole manopole Marguerite
Robinet mélangeur mural 2 trous avec col tournant poignées Marguerite
Wall mounted tap 2 holes with swivel spout Marguerite handles



■ **RKM21** • Rubinetto riempi pentola manopole Marguerite
Robinet de remplissage de casseroles poignées Marguerite
Pot filler tap Marguerite handles

NB. Tutti i modelli dei rubinetti sono disponibili con qualsiasi manopola vedi pag. 37 (vi preghiamo precisare sugli ordini modello manopola scelta insieme al codice rubinetto).
NB. Tous les modèles de robinets sont disponibles avec n'importe laquelle de nos poignées (voir page 37). Nous vous invitons, lors de votre commande, à nous préciser outre le code du robinet, le modèle de poignée souhaité. - NB. All the taps are available with any of our top handles (see page 37).
Please, when ordering, make sure to precise the model of the handle you want in addition to the code of the tap.

Bathtub Taps

 Robinets pour la baignoire
 Rubinetti per vasca

Taps Robinets
 Rubinetti



■ RVC111 • Gruppo vasca da pavimento con colonne CROIX
 Robinetterie baignoire avec jambes CROIX
 Free standing bathtub mixer CROIX



■ RVC112 • Gruppo vasca con colonne e porta salviette CROIX
 Robinetterie baignoire avec jambes et porte serviette CROIX
 Free standing bathtub mixer with towel rail CROIX

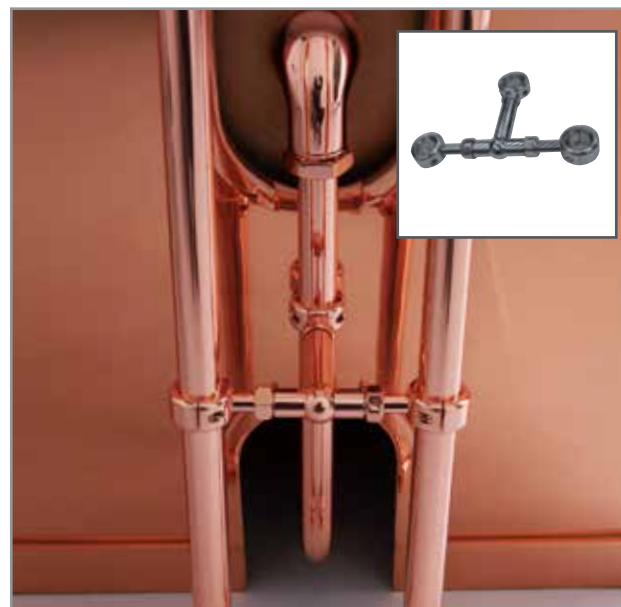

■ STBT • Staffa fissaggio gambe gruppo vasca
 Fixation colonnes pour RV111/112
 Column attachment for RV111/112



■ CS01 • Scarico vasca con catenella
 Vidage baignoire avec chaînette
 Bathtub waste with chain



■ CS02 • Colonna scarico vasca automatico
 Vidage baignoire automatique
 Automatic bathtub waste



■ CS03 • Colonna vasca incasso
 Vidage baignoire à encastrer
 Bathtub recessed waste

NB. Tutti i modelli dei rubinetti sono disponibili con qualsiasi manopola vedi pag. 37 (vi preghiamo precisare sugli ordini modello manopola scelta insieme al codice rubinetto).
 NB. Tous les modèles de robinets sont disponibles avec n'importe laquelle de nos poignées (voir page 37). Nous vous invitons, lors de votre commande, à nous préciser outre le code du robinet, le modèle de poignée souhaité. -NB. All the taps are available with any of our top handles (see page 37).
 Please, when ordering, make sure to precise the model of the handle you want in addition to the code of the tap.



Bathtub Taps

Robinets pour la baignoire
Rubinetti per vasca



■ **R VF110** • Gruppo vasca da muro FLEUR
Robinetterie baignoire murale FLEUR
Wall mounted bathtub mixer FLEUR



■ **R VL210** • Gruppo vasca da muro LUX
Robinetterie baignoire murale LUX
Wall mounted bathtub mixer LUX



■ **R VMT310** • Gruppo vasca da muro METROPOLITAN
Robinet baignoire mural METROPOLITAN
Wall mounted METROPOLITAN bath tap



■ **R VMT311** • Gruppo vasca da pavimento con colonne METROPOLITAN
Robinet baignoire de sol METROPOLITAN
Floor mounted METROPOLITAN bath tap

Robinets pour la baignoire
Rubinetti per vasca

Bathtub Taps

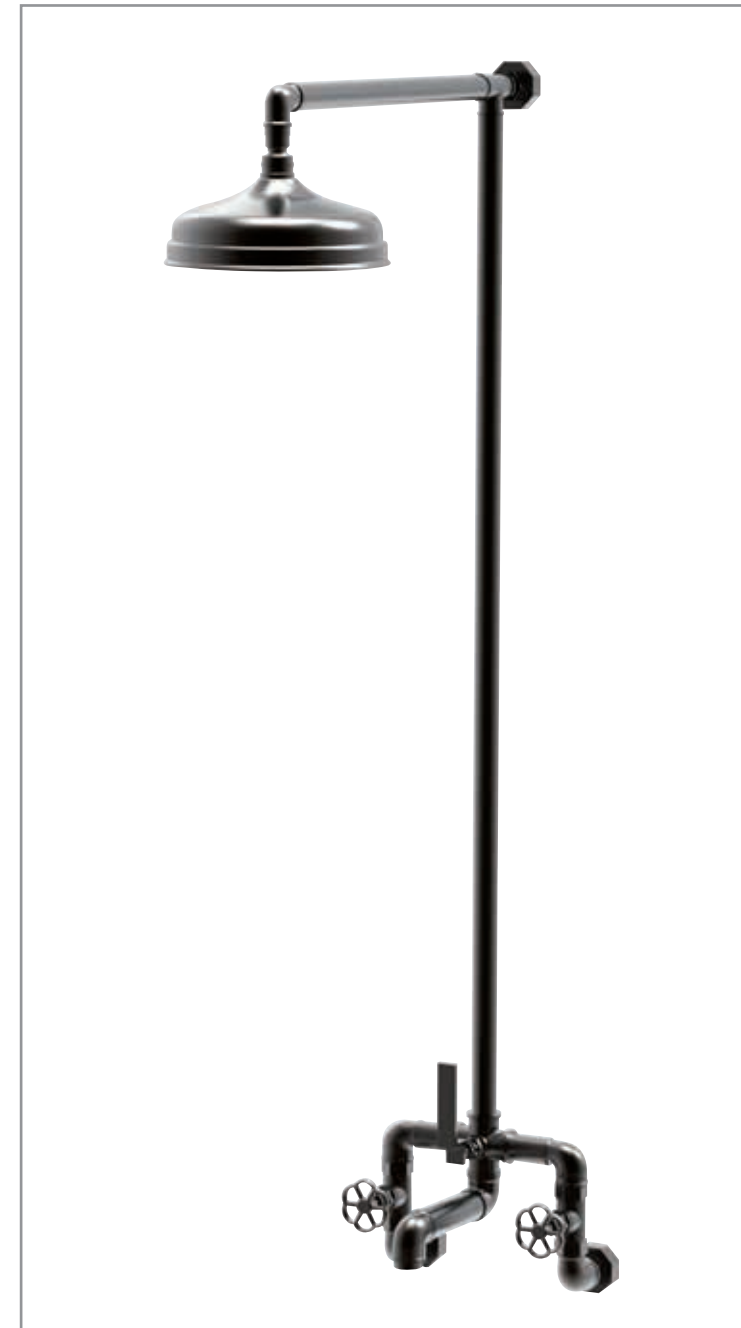

■ **R VMT314** • Gruppo vasca est.2 vie/asta/braccio/soffione (Ø.15/20/30 cm) METROPOLITAN
Robinet baignoire mural + inverseur + barre + pommeau (15/20/30cm) METROPOLITAN
Wall mounted bath tap + diverter + rod + shower head (15/20/30cm) METROPOLITAN





■ **R VMT313** • Gruppo vasca est.3 vie/asta/doccetta/braccio/soffione (Ø.15/20/30 cm) METROPOLITAN
Robinet baignoire mural + inverseur + barre + cable et douchette + pommeau (15/20/30cm) METROPOLITAN
Wall bath tap + diverter + rod + handset + shower head (15/20/30cm) METROPOLITAN

NB. Tutti i modelli dei rubinetti sono disponibili con qualsiasi manopola vedi pag. 37 (vi preghiamo precisare sugli ordini modello manopola scelta insieme al codice rubinetto).
NB. Tous les modèles de robinets sont disponibles avec n'importe laquelle de nos poignées (voir page 37). Nous vous invitons, lors de votre commande, à nous préciser outre le code du robinet, le modèle de poignée souhaité. - NB. All the taps are available with any of our top handles (see page 37).
Please, when ordering, make sure to precise the model of the handle you want in addition to the code of the tap.

NB. Tutti i modelli dei rubinetti sono disponibili con qualsiasi manopola vedi pag. 37 (vi preghiamo precisare sugli ordini modello manopola scelta insieme al codice rubinetto).
NB. Tous les modèles de robinets sont disponibles avec n'importe laquelle de nos poignées (voir page 37). Nous vous invitons, lors de votre commande, à nous préciser outre le code du robinet, le modèle de poignée souhaité. - NB. All the taps are available with any of our top handles (see page 37).
Please, when ordering, make sure to precise the model of the handle you want in addition to the code of the tap.

Bathtub Taps

 Robinets pour la baignoire
 Rubinetti per vasca

Taps Robinets
 Rubinetti



RVF113 • Gruppo vasca est.3 vie/asta/doccetta/braccio/soffione (Ø.15/20/30 cm) FLEUR
 Robinet baignoire mural + inverseur + barre + cable et douchette + pommeau (15/20/30cm) FLEUR
 Recessed wall mounted bath tap with diverter + rod + handset + shower head (15/20/30cm) FLEUR



RVC119 • Gruppo vasca est.3 vie/asta/doccetta/braccio/soffione (Ø.15/20/30 cm) FLEUR con porta tenda cm. 80x100
 Robinet baignoire mural + inverseur + barre + cable et douchette + pommeau (15/20/30cm) FLEUR + porte rideau cm. 80x100
 Recessed wall mounted bath tap with diverter + rod + handset + shower head (15/20/30cm) FLEUR + shower rail cm.80x100

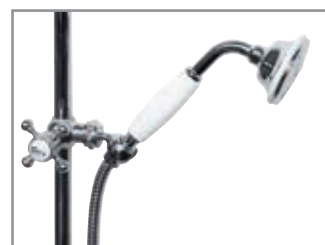

NB. Tutti i modelli dei rubinetti sono disponibili con qualsiasi manopola vedi pag. 37 (vi preghiamo precisare sugli ordini modello manopola scelta insieme al codice rubinetto).
 NB. Tous les modèles de robinets sont disponibles avec n'importe laquelle de nos poignées (voir page 37). Nous vous invitons, lors de votre commande, à nous préciser outre le code du robinet, le modèle de poignée souhaité. - NB. All the taps are available with any of our top handles (see page 37).
 Please, when ordering, make sure to precise the model of the handle you want in addition to the code of the tap.

Shower Taps

 Robinets pour douche
 Rubinetti per doccia

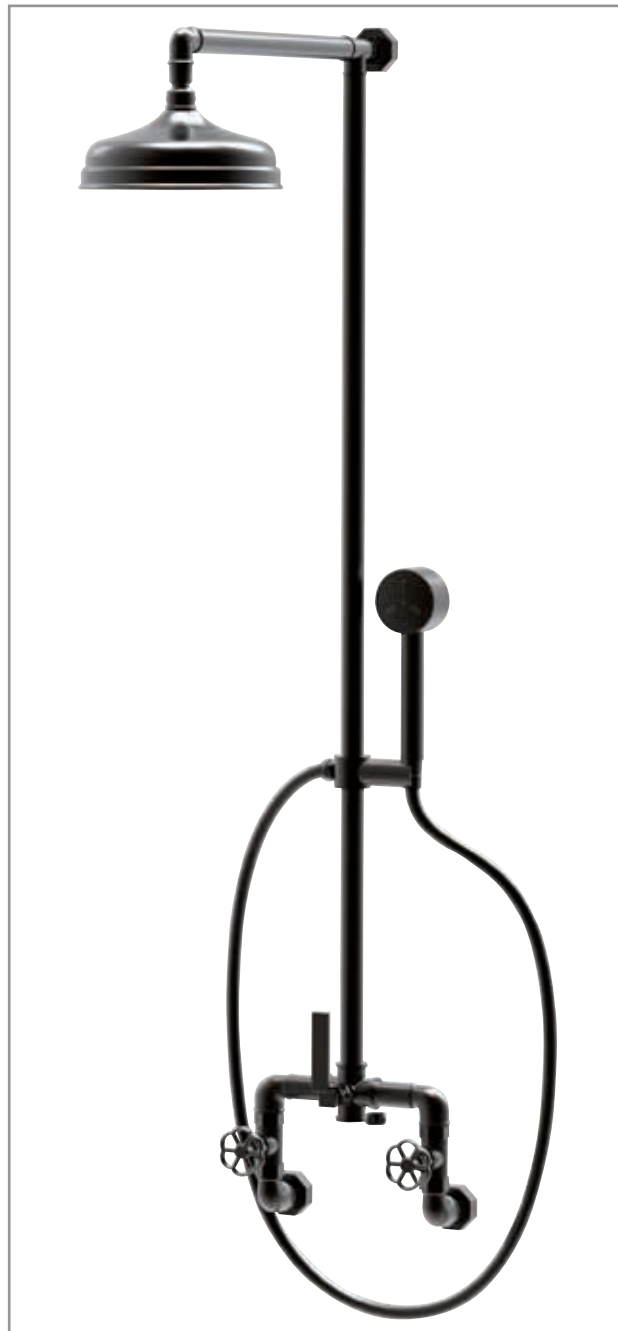

■ RDMT318 • Gruppo doccia est.duplex/asta/doc-
cetta/braccio/soffione (Ø.15/20/30 cm)
METROPOLITAN
Robinet douche mural METROPOLITAN avec in-
verseur + barre + cable & douchette + pommeau
(15/20/30cm)
Wall mounted shower tap METROPOLITAN + diver-
ter + rod + shower head (15/20/30cm)



■ RDL218 • Gruppo doccia con placca est.duplex/asta/doc-
cetta/braccio/soffione
(Ø.15/20/30 cm) LUX
Robinet douche mural LUX avec plaque et inverseur + barre + cable & douchet-
te + pommeau (15/20/30cm)
Recessed wall mounte shower tap LUX with plate and diverter + rod + handset +
shower head (15/20/30cm)



NB. Tutti i modelli dei rubinetti sono disponibili con qualsiasi manopola vedi pag. 37 (vi preghiamo precisare sugli ordini modello manopola scelta insieme al codice rubinetto).
 NB. Tous les modèles de robinets sont disponibles avec n'importe laquelle de nos poignées (voir page 37). Nous vous invitons, lors de votre commande, à
 nous préciser outre le code du robinet, le modèle de poignée souhaité. - NB. All the taps are available with any of our top handles (see page 37).
 Please, when ordering, make sure to precise the model of the handle you want in addition to the code of the tap.

Robinets pour douche 
 Rubinetti per doccia 

Shower Taps

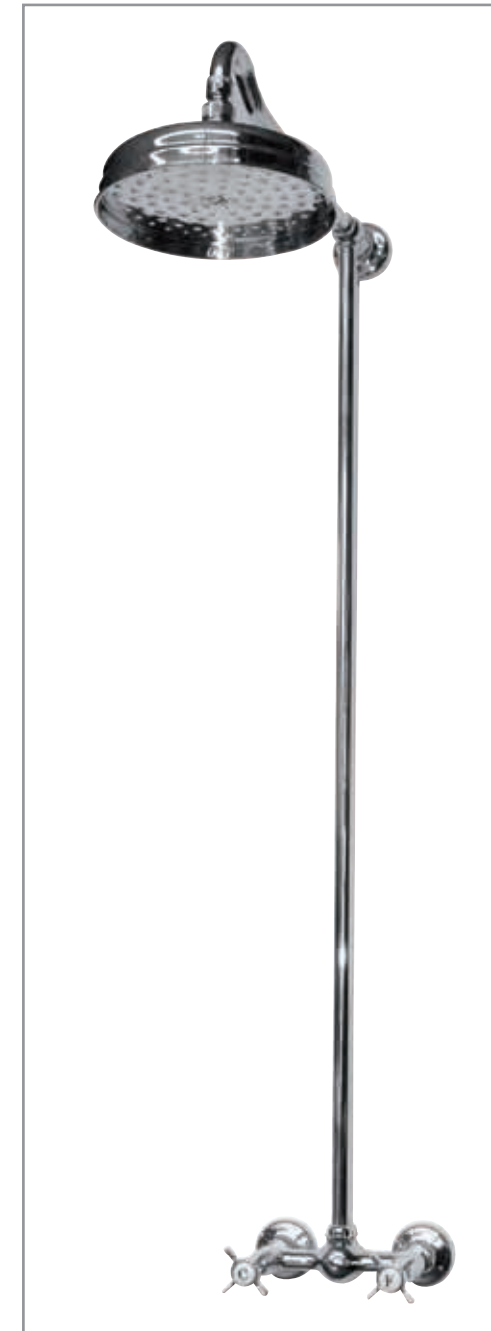

■ RDF114 • Gruppo doccia ester-
no FLEUR con asta e soffione
(Ø.15/20/30 cm) FLEUR
Robinet douche mural FLEUR avec
barre et pommeau (15/20/30cm)
Recessed wall mounted shower taps
FLEUR with rod and shower head
(15/20/30cm)



■ RDF118 • Gruppo
doccia est.duplex/asta/doccetta/braccio/
soffione (Ø.15/20/30 cm) FLEUR
Robinet douche mural FLEUR avec
inverseur + barre + cable & douchette
+ pommeau (15/20/30cm)
Recessed wall mounte shower taps
FLEUR with diverter + rod + handset +
shower head (15/20/30cm)



■ RDA118P • Gruppo doccia est.pon-
te duplex/asta/doccetta/braccio/
soffione (Ø.15/20/30 cm) ANIS
Robinet douche pont mural Anis avec
inverseur + barre + cable et douchette
+ pommeau (15/20/30cm)
Recessed wall mounted shower bridge
tap with diverter + rod + handset +
shower head (15/20/30cm) ANIS

NB. Tutti i modelli dei rubinetti sono disponibili con qualsiasi manopola vedi pag. 37
 (vi preghiamo precisare sugli ordini modello manopola scelta insieme al codice rubinetto).
 NB. Tous les modèles de robinets sont disponibles avec n'importe laquelle de nos poignées (voir page 37).
 Nous vous invitons, lors de votre commande, à nous préciser outre le code du robinet, le modèle de poignée souhaité.
 NB. All the taps are available with any of our top handles (see page 37).
 Please, when ordering, make sure to precise the model of the handle you want in addition to the code of the tap.

Shower Taps

 Robinets pour douche
 Rubinetti per doccia

Taps Robinets
 Rubinetti



RDC115 • Termostatico doccia est. duplex/asta/doccetta/braccio/soffione (Ø.15/20/30 cm) CROIX
 Mitigeur thermostatique douche chromé CROIX avec inverseur + barre + câble et douchette + pommeau (15/20/30cm)
 Chrome wall mounted thermostatic shower mixer with diverter + rod + handset + shower head (15/20/30cm) CROIX



RDA122 • Gruppo doccia monocomando est. duplex/asta/doccetta/braccio/soffione (Ø.15/20/30 cm) ANIS
 Robinet mitigeur douche mural avec inverseur + barre + câble + douchette + pommeau (15/20/30cm)
 Wall mounted shower mixer tap with diverter + rod + handset + shower head (15/20/30cm)



NB. Tutti i modelli dei rubinetti sono disponibili con qualsiasi manopola vedi pag. 37 (vi preghiamo precisare sugli ordini modello manopola scelta insieme al codice rubinetto).
 NB. Tous les modèles de robinets sont disponibles avec n'importe laquelle de nos poignées (voir page 37). Nous vous invitons, lors de votre commande, à nous préciser outre le code du robinet, le modèle de poignée souhaité. - NB. All the taps are available with any of our top handles (see page 37).
 Please, when ordering, make sure to precise the model of the handle you want in addition to the code of the tap.

Shower Taps

Robinets pour douche
Rubinetti per doccia



- **RDMT318.2** • Freestanding METROPOLITAN doccia 4 fori asta/ doccetta/braccio/sof-fione (Ø.15/20/30 cm)
Robinet METROPOLITAN sur pieds douche 4 trous+ inverseur + barre + cable et douchette + pommeau (15/20/30cm)
METROPOLITAN freestanding shower tap 4 holes + diverter + rod + handset + shower head (15/20/30cm) METROPOLITAN



- **RDF123** • Doccia reticolare con soffione Ø 30 cm con anello porta tenda e con 6 barre con getti doccia, flessibile e doccetta
Douche circulaire avec pommeau Ø 30 cm + anneau porte ride-au + 6 barres jet douche + douchette et son flexible
Round shower with Ø 30 cm shower head + shower curtain rail + 6 shower jet bars + shower handset

NB. Tutti i modelli dei rubinetti sono disponibili con qualsiasi manopola vedi pag. 37 (vi preghiamo precisare sugli ordini modello manopola scelta insieme al codice rubinetto).
NB. Tous les modèles de robinets sont disponibles avec n'importe laquelle de nos poignées (voir page 37). Nous vous invitons, lors de votre commande, à nous préciser outre le code du robinet, le modèle de poignée souhaité.
NB. All the taps are available with any of our top handles (see page 37). Please, when ordering, make sure to precise the model of the handle you want in addition to the code of the tap.

Robinets pour douche
Rubinetti per doccia

Shower Taps



- **RD120** • Soffione doccia 20 cm con braccio (Ø.15/20/30cm)
Pommeau de douche 20 cm avec bras (Ø.15/20/30cm)
Shower head 20cm with handset (Ø.15/20/30cm)



- **RD120S** • Soffione doccia 20 cm con braccio a soffitto (Ø.15/20/30cm)
Pommeau de douche relié au plafond (15/20/30cm)
Ceiling showerhead (15/20/30cm)



- **RD120D** • Soffione doccia DECORATO 20 cm con braccio (15/20/30cm)
Pommeau de douche décoré (15/20/30cm) avec bras
Decorated shower head (15/20/30cm) with handset



- **RDC116** • Miscelatore termostatico incasso
Mitigeur thermostatique encastré
Thermostatic mixer for shower



- **RDDEV** • Deviatore da incasso 2 vie
Inverseur mural 2 voies
2-way built-in diverter



- **RDMAN** • Doccetta con flessibile 150 cm.
Douchette et son flexible 150 cm.
Shower handset with cable 150 cm.



- **RDA117** • Miscelatore doccia incasso con deviatore ANIS
Mitigeur douche chromé encastré avec inverseur – poignée ANIS
Shower mixer recessed with diverter – ANIS handle



- **RDGAN** • Presa acqua doccia con gancio
Prise eau douchette avec support
Plug for shower handset with hook



- **RDWC** • Doccetta wc shut off con flessibile 150 cm. e miscelatore a muro
Douchette shut off avec flexible 150 cm. et robinet d'arrêt.
Shut off handset with 150 cm. cable and stop handle.

NB. Tutti i modelli dei rubinetti sono disponibili con qualsiasi manopola vedi pag. 37 (vi preghiamo precisare sugli ordini modello manopola scelta insieme al codice rubinetto).
NB. Tous les modèles de robinets sont disponibles avec n'importe laquelle de nos poignées (voir page 37). Nous vous invitons, lors de votre commande, à nous préciser outre le code du robinet, le modèle de poignée souhaité.
NB. All the taps are available with any of our top handles (see page 37). Please, when ordering, make sure to precise the model of the handle you want in addition to the code of the tap.

Heated Towel Rails

Chauffe serviettes
Scaldasalviette



Chauffe serviettes
Scaldasalviette

DISPONIBILE ANCHE IN VERSIONE ELETTRICA O MISTA
AUSSI DISPONIBLE EN VERSION ELECTRIQUE OU MIXTE
ALSO AVAILABLE ELECTRIC OR MIXED



■ **SSPTC3** • Radiatore a muro 3 barre mm.650x480
DT60° 274 Kcal/h - 318 Watt
Radiateur mural 3 barres mm.650x480
DT60° 274 Kcal/h - 318 Watt
Wall mounted radiator with 3 rails mm.650x480
DT60° 274 Kcal/h - 318 Watt

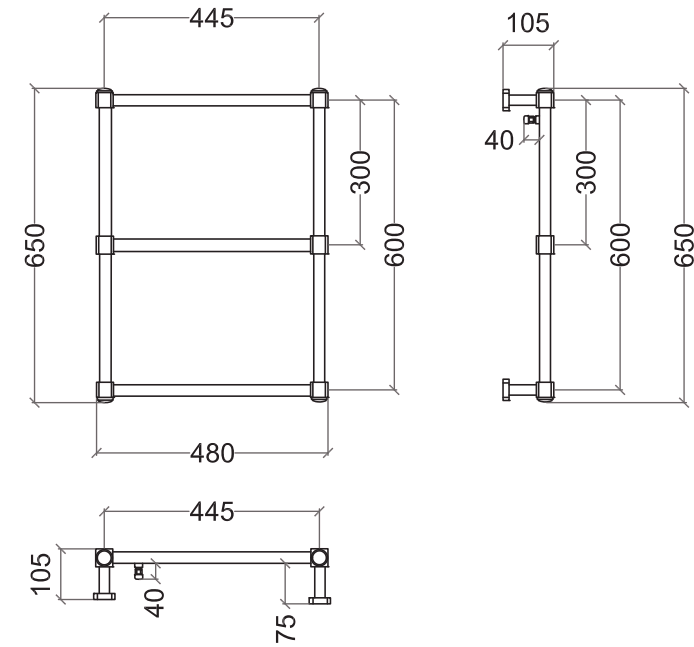

■ **SSPLUX5** • Radiatore a muro 5 barre mm.860x560 DT60°
350 Kcal/h - 406 Watt
Radiateur mural 5 barres mm.860x560
DT60° 350 Kcal/h - 406 Watt
Wall mounted radiator with 5 rails mm.860x560
DT60° 350 Kcal/h - 406 Watt

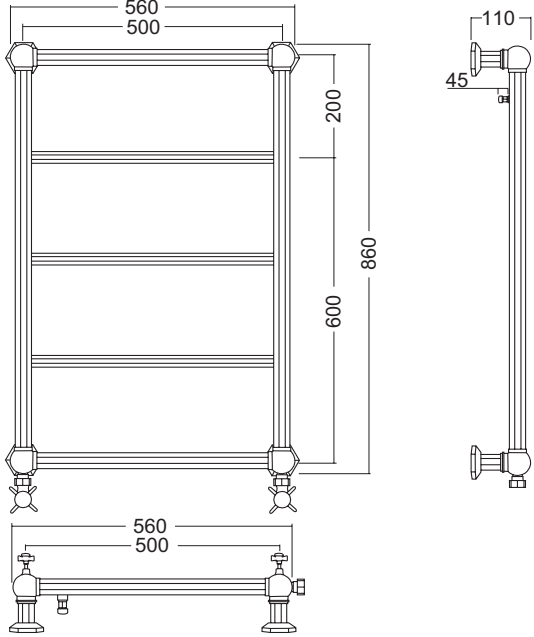

Heated Towel Rails

Chaque serviette
Scaldasalvietta



DISPONIBILE ANCHE IN VERSIONE ELETTRICA O MISTA
AUSSI DISPONIBLE EN VERSION ELECTRIQUE OU MIXTE
ALSO AVAILABLE ELECTRIC OR MIXED



■ **SSPGR6** • Radiatore a muro 6 barre + griglia mm.1140x550 DT60° 520 Kcal/h - 603 Watt
Radiateur mural 6 barres avec grille mm.1140x550 DT60° 520 Kcal/h - 603 Watt
Wall mounted radiator with 6 rails + grid mm.1140x550 DT60° 520 Kcal/h - 603 Watt

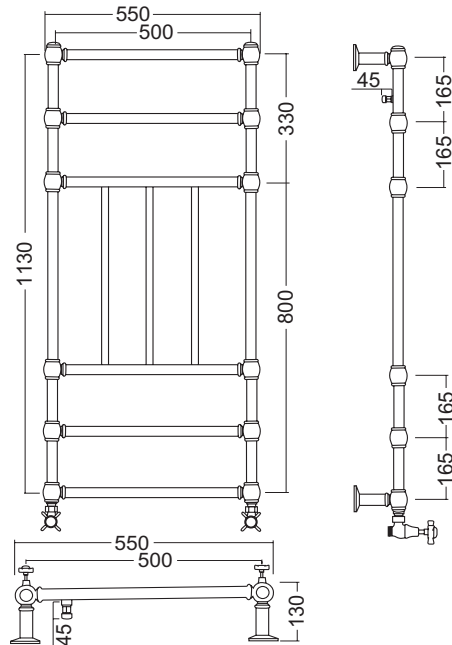

■ **SSERP6** • Radiatore a muro serpentina 6 barre mm.785x530 DT60° 160 Kcal/h - 185 Watt
Radiateur mural serpentin 6 barres mm.785x530 DT60° 160 Kcal/h - 185 Watt
Wall mounted radiator with 6 rails mm.760x650 DT60° 160 Kcal/h - 185 Watt

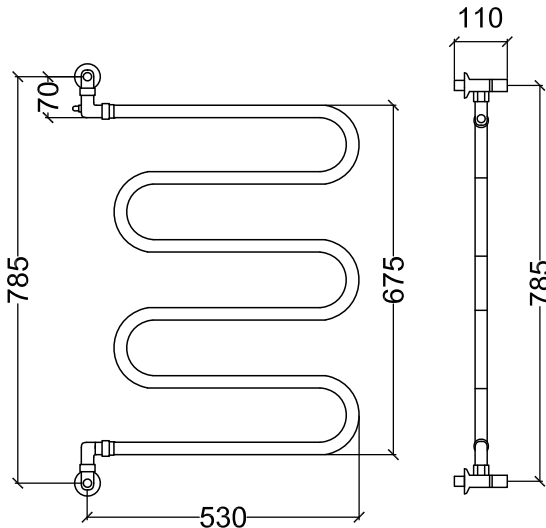

■ **SSPMT4** • Radiatore a muro METROPOLITAN 4 barre mm.740x495 250 Kcal/h
Radiateur mural METROPOLITAN 4 barres mm.740x495-250 Kcal/h
Wall mounted METROPOLITAN radiator with 4 rails mm.740x495-250 Kcal/h

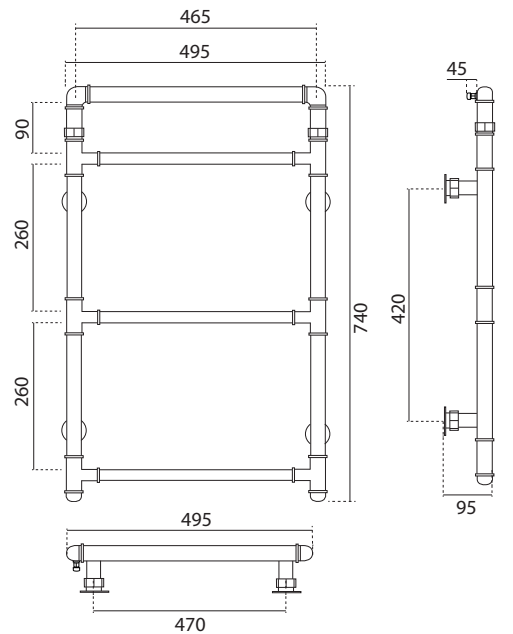

Heated Towel Rails

Chaufte serviettes
Scaldasalviette



Chaufte serviettes
Scaldasalviette

Heated Towel Rails

DISPONIBILE ANCHE IN VERSIONE ELETTRICA O MISTA
AUSSI DISPONIBLE EN VERSION ELECTRIQUE OU MIXTE
ALSO AVAILABLE ELECTRIC OR MIXED



SSARC1 • Radiatore a muro ad arco con griglia mm.990x530 DT60° 422 Kcal/h - 481 Watt
Radiateur mural arc avec grille mm.990x530 DT60° 422 Kcal/h - 481 Watt
Wall mounted arch radiator with grid mm.990x530 DT60° 422 Kcal/h - 481 Watt



SSARC2 • Radiatore a muro ad arco 5 barre mm.1000x600 DT60° 530 Kcal/h - 615 Watt
Radiateur mural arc 5 barres mm.1000x600 DT60° 530 Kcal/h - 615 Watt
Wall mounted arch radiator with 5 rails mm.1000x600 DT60° 530 Kcal/h - 615 Watt



SSARC3 • Radiatore a muro ad arco 3 barre mm.990x530 - DT60° 422 Kcal/h - 481 Watts
Radiateur Mural arc 3 barres mm.990x530 - DT60° 422 Kcal/h - 481 Watts
Wall mounted arc radiator 3 rails mm.990x530 DT60° 422 Kcal/h - 481 Watts

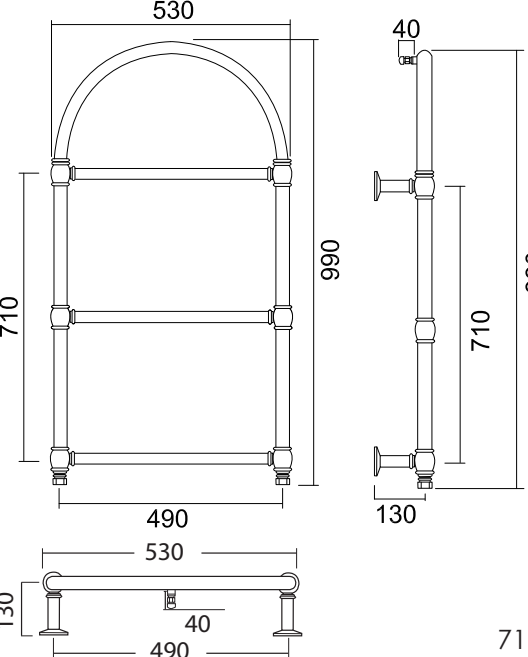
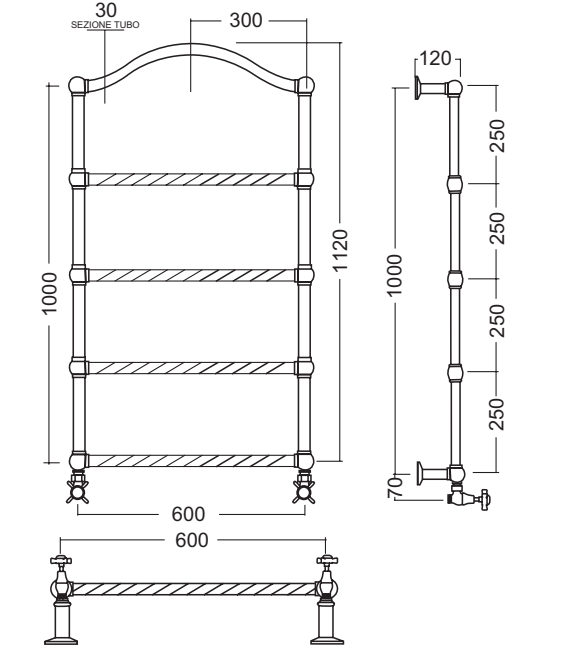
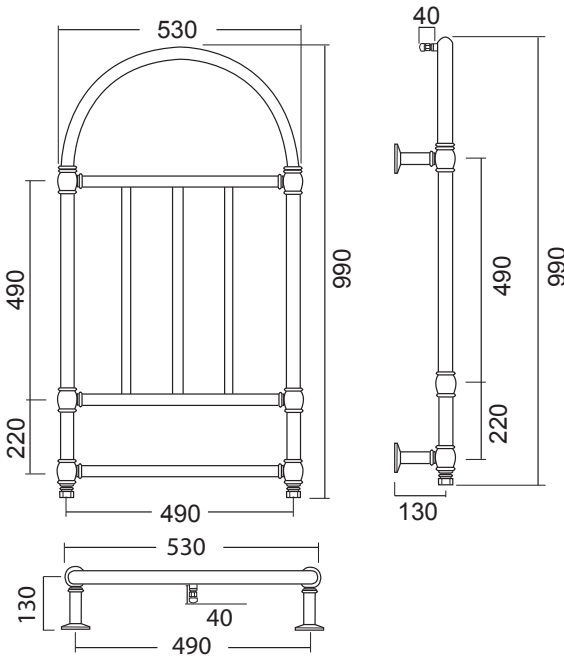

Heated Towel Rails

Chaque serviette
Scaldasalvietta



Chaque serviette
Scaldasalvietta

Heated Towel Rails

DISPONIBILE ANCHE IN VERSIONE ELETTRICA O MISTA
AUSSI DISPONIBLE EN VERSION ELECTRIQUE OU MIXTE
ALSO AVAILABLE ELECTRIC OR MIXED



■ **SSPVB3** • Radiatore a pavimento con inserto in ghisa mm.1185x545
DT60° Kcal/h 623,6 - Watt 723
Radiateur de sol avec insert en fonte 1185x545mm.
DT60° Kcal/h 623,6 - Watt 723
Floor mounted radiator with cast iron insert 1185x545mm.
DT60° Kcal/h 623,6 - Watt 723



■ **SSPVN3/1** • Radiatore a pavimento con inserto in ghisa nero e barra porta salviette mm.1185x545
DT60° Kcal/h 653,6 - Watt 758
Radiateur de sol noir avec insert en fonte et barre porte serviette 1185x545mm.
DT60° Kcal/h 653,6 - Watt 758
Floor mounted radiator with cast iron insert and towel rail 1185x545mm.
DT60° Kcal/h 653,6 - Watt 758



■ **SSPINSB4** • Radiatore a muro con inserto in ghisa bianco mm.960x485
DT60° 582Kcal/h - 675 Watt
Radiateur mural avec insert en fonte blanche mm.960x485
DT60° 582Kcal/h - 675 Watt
Wall mounted radiator with white cast iron insert mm.960x485
DT60° 582Kcal/h - 675 Watt

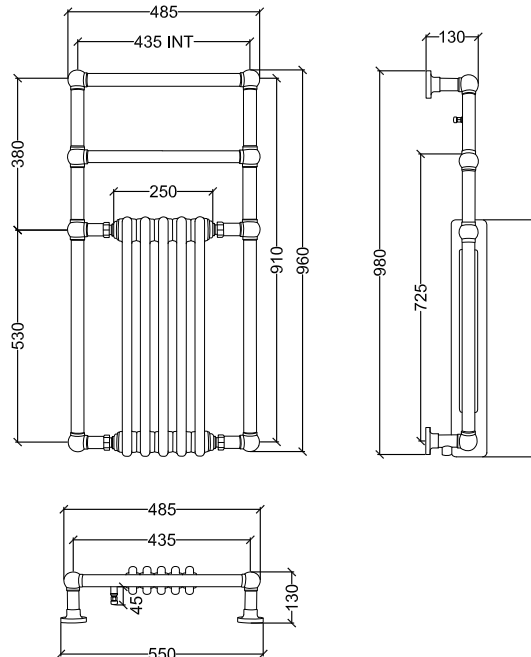
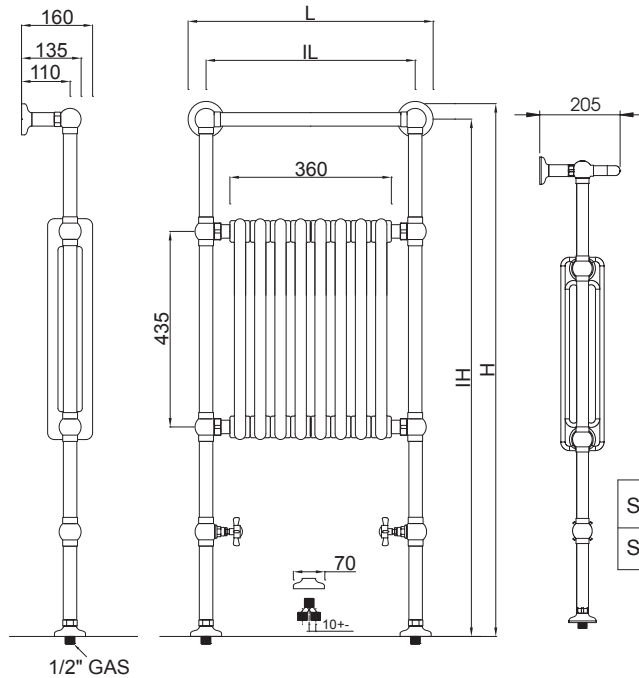

Heated Towel Rails

🇫🇷 Chauffe serviettes
🇮🇹 Scaldasalviette



Chauffe serviettes 🇫🇷
 Scaldasalviette 🇮🇹

DISPONIBILE ANCHE IN VERSIONE ELETTRICA O MISTA
 AUSSI DISPONIBLE EN VERSION ELECTRIQUE OU MIXTE
 ALSO AVAILABLE ELECTRIC OR MIXED



■ **SSCA7** • Radiatore a cavalletto da pavimento mm.850x805 DT60° Kcal/h 762 - Watt 884
 Radiateur chevalet de sol mm.850x805 DT60° Kcal/h 762 - Watt 884
 Floor mounted easel radiator mm.850x805 DT60° Kcal/h 762 - Watt 884

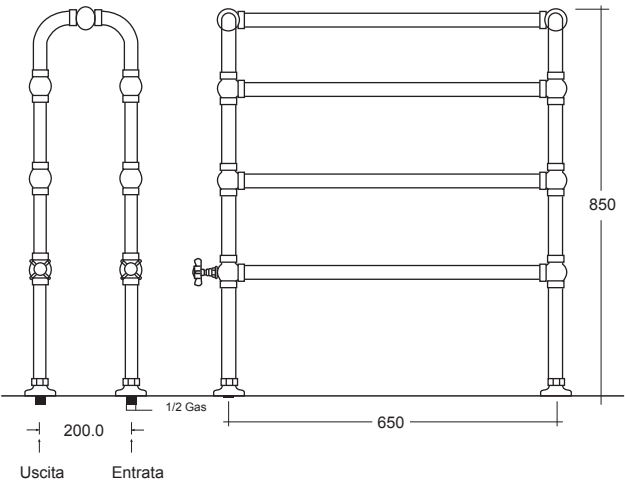

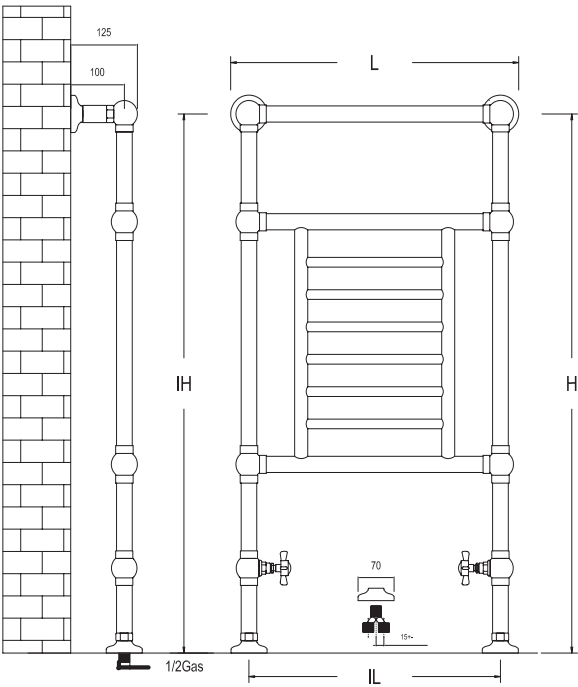

■ **SSPV3** • Radiatore a pavimento 3 barre (diverse dimensioni disponibili)
 Radiateur de sol 3 barres (plusieurs dimensions disponibles)
 Floor mounted radiator with 3 rails (several sizes available)



Code	H	L	IH	IL	Kcal.
SSPV 3/1	1185	570	1150	500	792
SSPV 3/2	1185	670	1150	600	844

Heated Towel Rails

 Chauffe serviettes

 Scaldasalviette





 Chauffe serviettes

 Scaldasalviette

DISPONIBILE ANCHE IN VERSIONE ELETTRICA O MISTA
 AUSSI DISPONIBLE EN VERSION ELECTRIQUE OU MIXTE
 ALSO AVAILABLE ELECTRIC OR MIXED

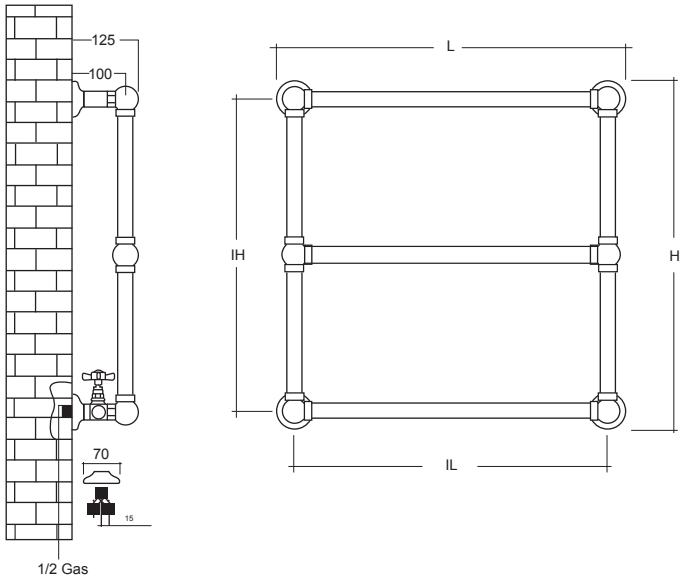

■ **SSP3** • Radiatore a parete 3 barre (diverse dimensioni disponibili)
 Radiateur mural 3 barres (plusieurs dimensions disponibles)
 Wall mounted radiator with 3 rails (several sizes available)



CODE	H	L	IH	IL	K.cal.	Watt.
SSP 3/1	620	620	550	550	390	454
SSP 3/2	620	820	550	750	468	544
SSP 3/3	820	420	750	350	364	423
SSP 3/4	820	520	750	450	403	469

Heated Towel Rails



■ **SSP5** • Radiatore a parete 5 barre (diverse dimensioni disponibili)
 Radiateur mural 5 barres (plusieurs dimensions disponibles)
 Wall mounted radiator with 5 rails (several sizes available)

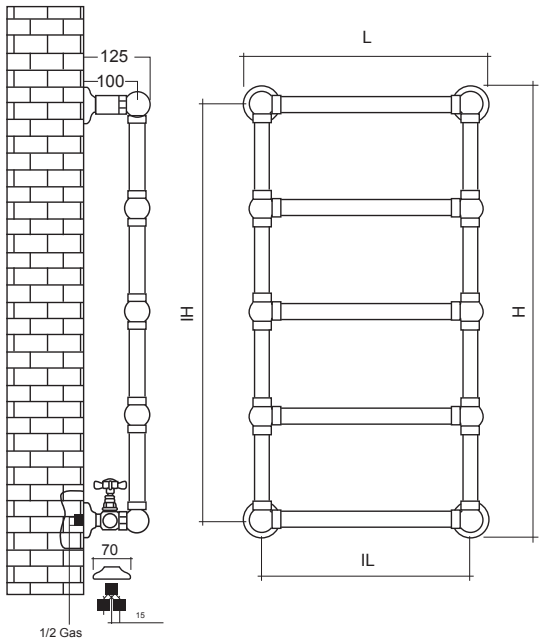

CODE	H	L	IH	IL	K.cal.	Watt.
SSP 5/1	870	470	800	400	514	598
SSP 5/2	870	570	800	500	579	673
SSP 5/3	1070	470	1000	400	566	658
SSP 5/4	1070	570	1000	500	631	734

Heated Towel Rails

 Chauffe serviettes

 Scaldasalviette



Chauffe serviettes 
 Scaldasalviette 

DISPONIBILE ANCHE IN VERSIONE ELETTRICA O MISTA
 AUSSI DISPONIBLE EN VERSION ELECTRIQUE OU MIXTE
 ALSO AVAILABLE ELECTRIC OR MIXED



SSCAP1 • Radiatore porta salviette DT60° Kcal/h 293.8 - Watt 340
 Radiateur mural porte serviettes DT60° Kcal/h 293.8 - Watt 340
 Wall mounted towel holder radiator DT60° Kcal/h 293.8 - Watt 340

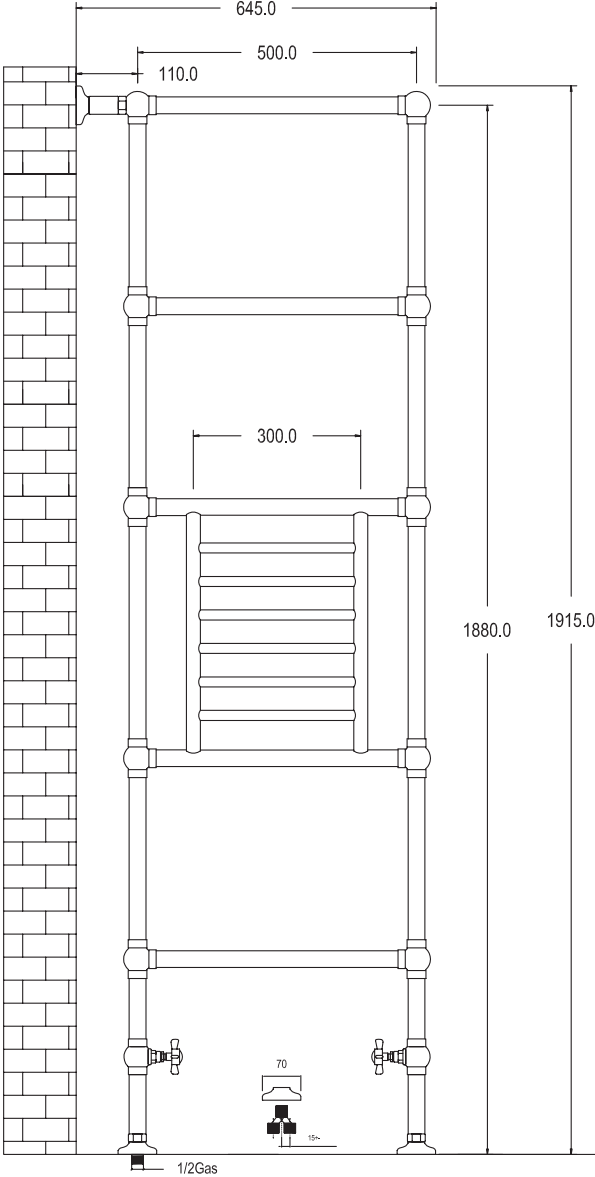
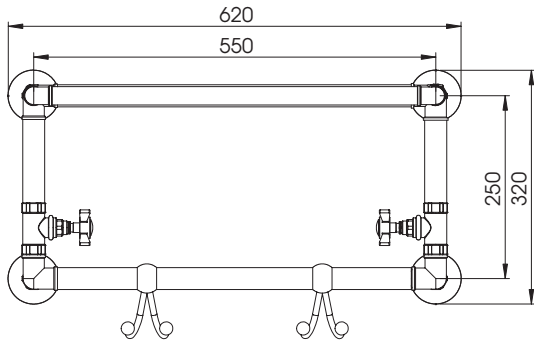
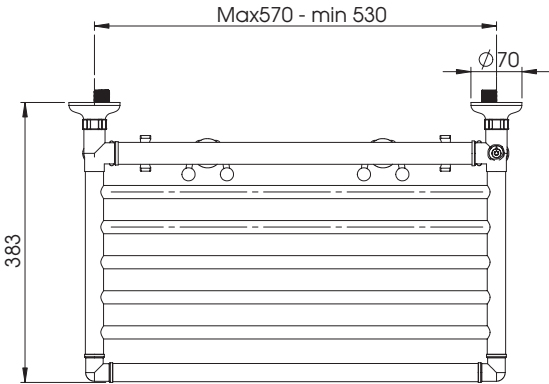

SSPV5DG
 Radiatore a pavimento 5 barre mm.1915x645 DT60° Kcal/h 706.5 - Watt 819.5
 Radiateur de sol 5 barres mm.1915x645 DT60° Kcal/h 706.5 - Watt 819.5
 Floor mounted radiator with 5 rails mm.1915x645 DT60° Kcal/h 706.5 - Watt 819.5

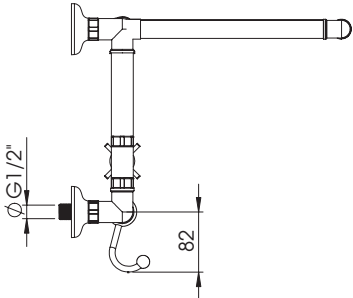

Heated Towel Rails

🇫🇷 Chauffe serviettes
🇮🇹 Scaldasalviette

DISPONIBILE ANCHE IN VERSIONE ELETTRICA O MISTA
 AUSSI DISPONIBLE EN VERSION ELECTRIQUE OU MIXTE
 ALSO AVAILABLE ELECTRIC OR MIXED



SSP8 • Radiatore a parete 8 barre (diverse dimensioni disponibili)
 Radiateur mural 8 barres (plusieurs dimensions disponibles)
 Wall mounted radiator with 8 rails (several sizes available)



SSPV6DG • Radiatore a pavimento 6 barre
 2450x870mm - Watt 600
 Radiateur de sol 6 barres 2450x870mm - Watt 600
 Floor mounted radiator with 6 rails 2450x870mm - Watt 600

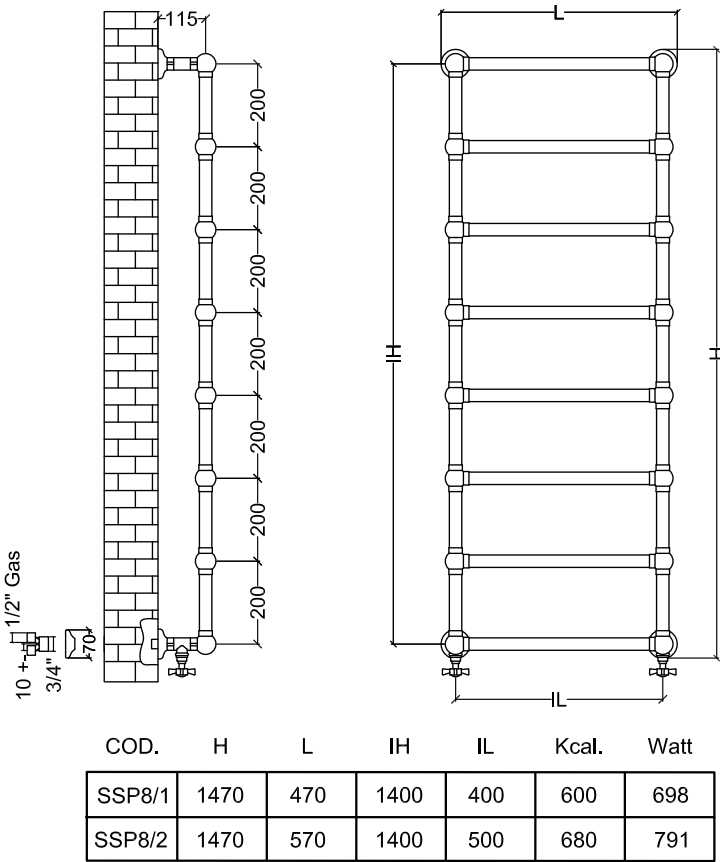

Chauffe serviettes 🇫🇷
 Scaldasalviette 🇮🇹

DISPONIBILE ANCHE IN VERSIONE ELETTRICA O MISTA
 AUSSI DISPONIBLE EN VERSION ELECTRIQUE OU MIXTE
 ALSO AVAILABLE ELECTRIC OR MIXED



SSP4/4 • Radiatore a parete 4 barre 875x570mm
 Watt 550
 Radiateur mural 4 barres 875x570mm - Watt 550
 Wall mounted radiator with 4 rails 875x570mm - Watt 550

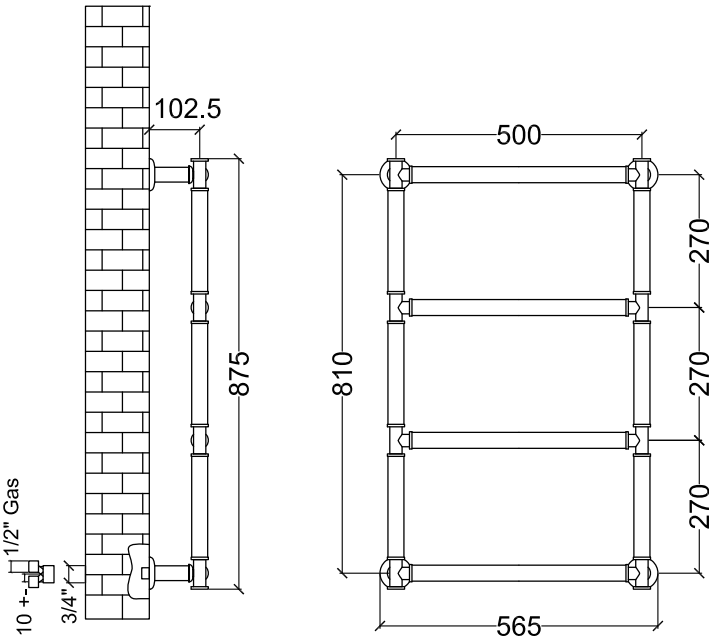

SSPMT5 • Radiatore a parete 5 barre 1030x570mm
 Watt 450
 Radiateur mural 5 barres 1030x570mm - Watt 450
 Wall mounted radiator with 5 rails 1030x570mm - Watt 450

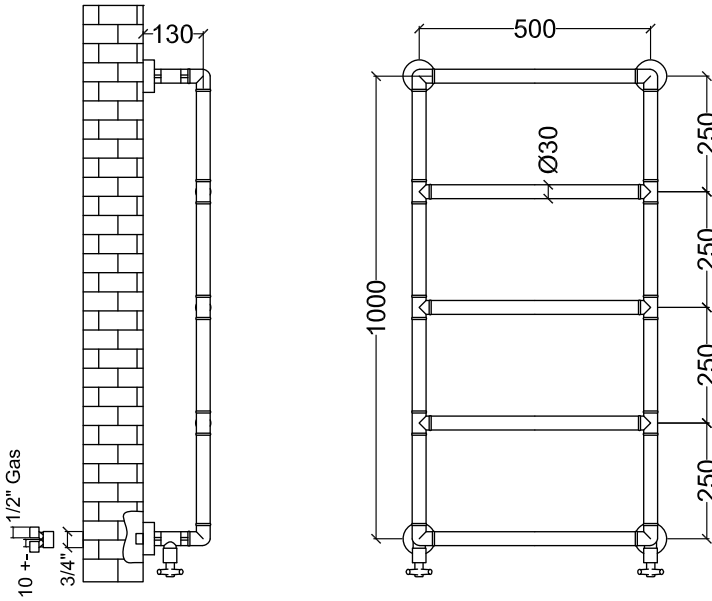

METAL FINISHING

Finiture Metalli
Finition de Métaux



RAL

Bianco Mat
Matte White
Blanc Mat



CR

Cromo
Chrome
Chrome



NK

Nichel
Nickel
Nickel



NS

Nichel Mat
Matte Nickel
Nickel Mat



ON

Ottone Naturale
Natural Brass
Laiton Naturel



OR

Oro Chiaro
Light gold
Or Clair



OG

Oro Scuro
Dark Gold
Or Fonce



OM

Oro Mat
Matte Gold
Or Mat



ORR

Oro Rosa
Gold Pink
Or Rose



RM

Rame
Copper
Cuivre



RS

Rame Mat
Matte Copper
Cuivre Mat



RA

Rame Antico
Old Copper
Cuivre Ancien



RAL

Nero Mat
Matte Black
Noir Mat



CT

Corten
Corten
Corten



NN

Nichel Nero
Black Nickel
Nickel Noir



NNS

Nichel Nero Mat
Matte Black Nickel
Nickel Noir Mat



BR

Bronzo Chiaro
Light Bronze
Bronze Clair



BG

Bronzo Scuro
Dark Bronze
Bronze Fonce

EN All our brass products can be done with the following finishes.
IT Tutti i nostri prodotti in ottone si possono avere nelle seguenti finiture.
FR Tous les produits en laiton peuvent avoir les finitions suivantes.

HOW TO CLEAN YOUR TAPS

Come pulire i vostri rubinetti
Comment nettoyer vos robinets

EN Cleaning your faucet does not have to be a time-consuming task. When turning off your faucet with wet hands, you almost always leave drops of water on it. These dry and leave limescale behind. Visible limescale can form quickly, so you should dry the surface of your faucet with a microfibre cloth after each use. This will allow you to extend the intervals between regular cleanings.

Follow these simple tips to regularly clean and remove limescale from your faucet to easily keep it looking like new for years to come:

- Clean with warm water, a gentle soap (Neutral pH), and a soft microfibre cloth or sponge but be sure to avoid harsh and abrasive chemicals and cleaners.
- Never use scouring pads, steel wool, or any other hard scrubbing pad.

N.B. These tips are applicable for all metal finishes.

ITA La pulizia del rubinetto non deve essere un compito che richiede troppo tempo. Quando si chiude il rubinetto con le mani bagnate, quasi sempre vengono lasciate sopra delle gocce d'acqua. Queste si asciugano e lasciano dietro il calcare. Il calcare visibile può formarsi rapidamente, quindi si deve asciugare la superficie del rubinetto con un panno in microfibra dopo ogni utilizzo. Ciò consentirà di prolungare gli intervalli tra le pulizie regolari.

Seguire questi semplici consigli per pulire regolarmente e rimuovere il calcare dal rubinetto per mantenerlo facilmente come nuovo per gli anni a venire:

- Pulire con acqua tiepida, un sapone delicato (pH neutro) e un panno morbido in microfibra o una spugna, ma assicurarsi di evitare prodotti chimici e detergenti aggressivi e abrasivi.
- Non utilizzare mai spugnette abrasive, lana d'acciaio o qualsiasi altra spugna dura.

N.B. Questi suggerimenti sono applicabili a tutte le finiture metalliche.

FR Le nettoyage de votre robinet ne doit pas être une tâche fastidieuse. Lorsque vous fermez votre robinet avec les mains mouillées, vous laissez presque toujours des gouttes d'eau dessus. Ceux-ci séchent et laissent du calcaire derrière eux. Le calcaire visible peut se former rapidement, vous devez donc essuyer la surface de votre robinet avec un chiffon en microfibre après chaque utilisation. Cela vous permettra de prolonger les intervalles entre les nettoyages réguliers.

Suivez ces conseils simples pour nettoyer et éliminer régulièrement le calcaire de votre robinet afin de le garder facilement comme neuf pour les années à venir :

- Nettoyez avec de l'eau tiède, un savon doux (pH neutre) et un chiffon doux en microfibre ou une éponge, mais assurez-vous d'éviter les produits chimiques et nettoyants agressifs et abrasifs.
- N'utilisez jamais de tampons à récurer, de laine d'acier ou tout autre tampon à récurer dur.

N.B. Ces conseils sont applicables pour toutes les finitions métalliques.



BLEU  PROVENCE

Via Cristoforo Colombo, 223/225

00147 Rome (RM) - ITALY

TEL.+39.331.9204888

info@bleuprovence.it

WWW.BLEUPROVENCE.IT